

R-22W

9

355TH ST

EAGLE AVE

28

27

26

9

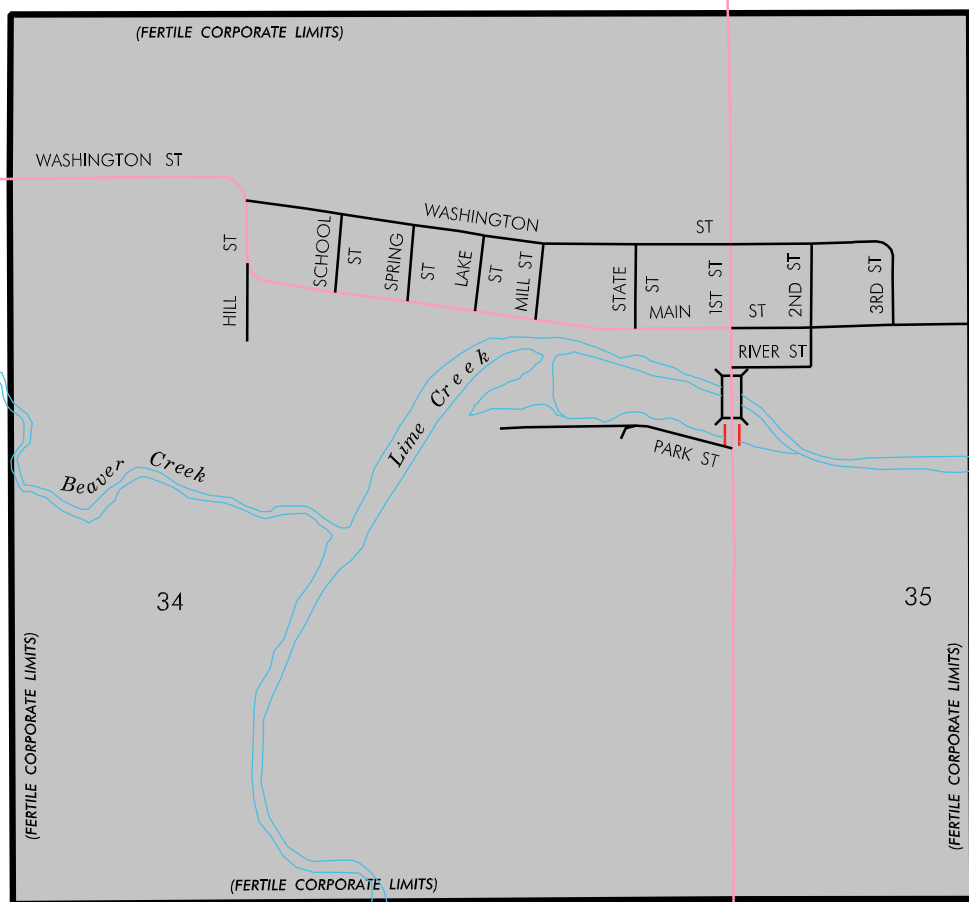

33

34

35

DOGWOOD AVE

T-98N

T-97N

4

3

2

WORTH COUNTY
CERRO GORDO COUNTY

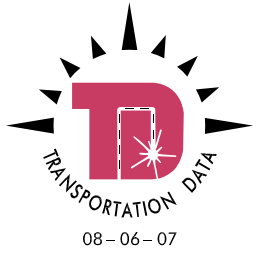

LEGEND

- INTERSTATE ROUTE
- FREEWAY OR EXPRESSWAY ROUTE
- U.S. NUMBERED ROUTE
- STATE NUMBERED ROUTE
- COUNTY NUMBERED ROUTE
- LOCAL ROAD OR CITY STREET
- RAILROAD
- CORPORATION LINE
- SECTION LINE
- CUL DE SAC
- SECTION, TOWNSHIP & RANGE NUMBERS

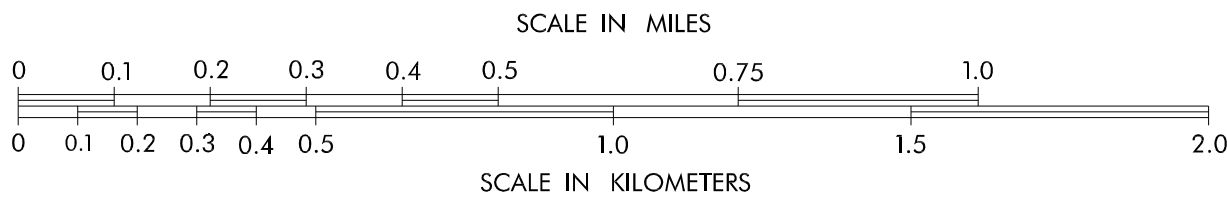
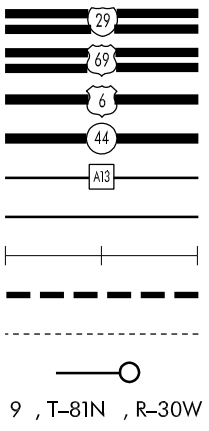

HIGHWAY AND STREET MAP
OF
FERTILE
IOWA

PREPARED BY
IOWA DEPARTMENT OF TRANSPORTATION
DIVISION OF PLANNING AND PROGRAMMING
OFFICE OF TRANSPORTATION DATA
PHONE (515) 239-1289
IN COOPERATION WITH
UNITED STATES DEPARTMENT OF TRANSPORTATION
FEDERAL HIGHWAY ADMINISTRATION

98-2547