

For line information, see [PM-110](#).

① If distance X is less than 3000 feet, omit last R4-3 sign. If distance X is greater than 5250 feet, place R4-3 signs at 2250 foot intervals.

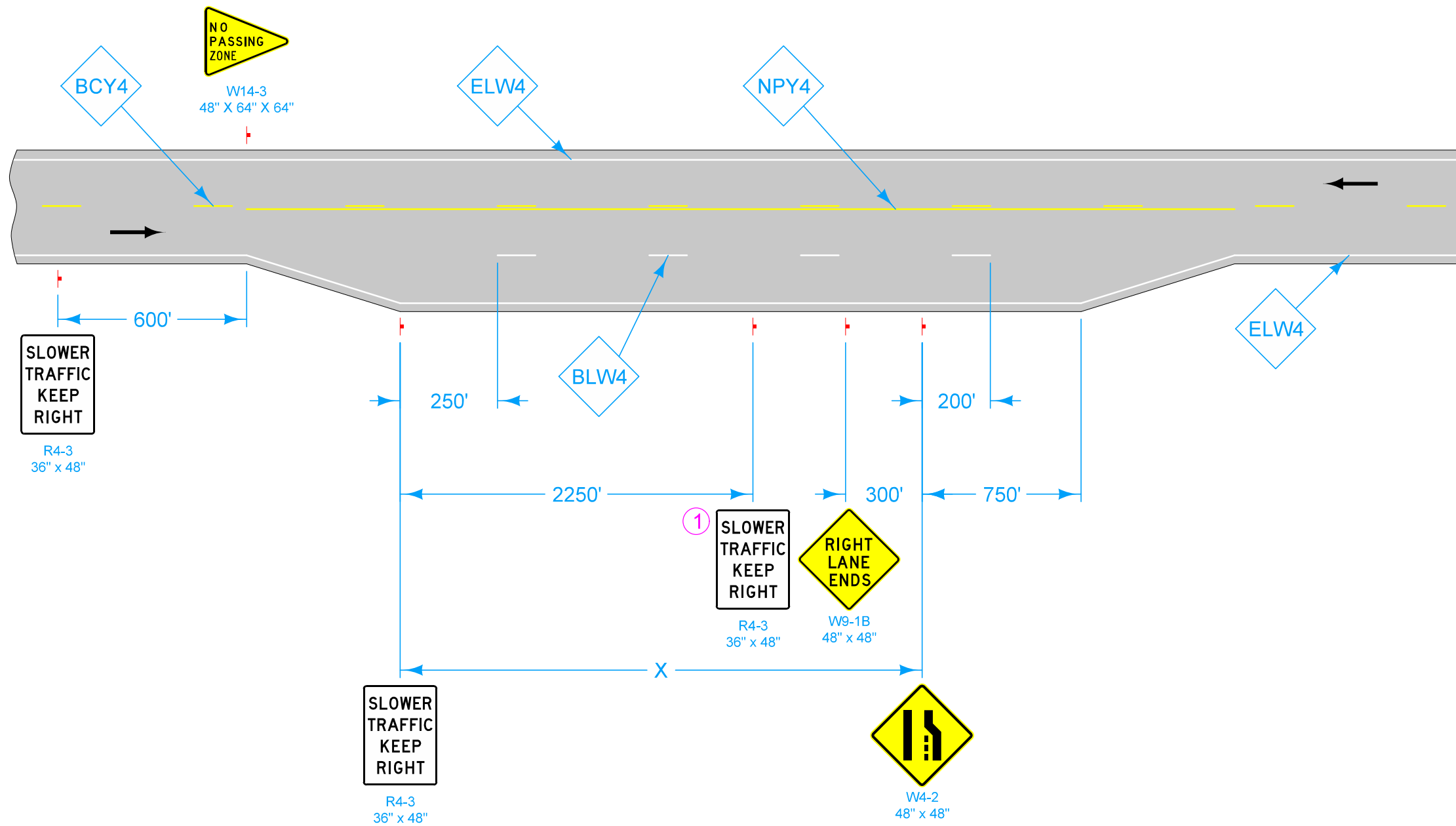

| LEGEND | |
|--------|-------------------------------|
| | Direction of Traffic |
| BCY4 | Broken Centerline (Yellow) |
| BLW4 | Broken Lane Line (White) |
| ELW4 | Edge Line Right (White) |
| NPY4 | No Passing Zone Line (Yellow) |

Possible Contract Item:
Pavement Marking Line Items
Type 'A' Signs

Possible Tabulation:
108-22

| | | |
|--|----------|---------------|
| | REVISION | |
| | 1 | 10-18-16 |
| STANDARD ROAD PLAN | | PM-221 |
| | | SHEET 1 of 1 |
| REVISIONS: Changed No Passing Zone sign size from 48" x 60" x 60" to 48" x 64" x 64". Replaced old DOT logo with new DOT logo. | | |
| | | |
| APPROVED BY DESIGN METHODS ENGINEER | | |
| CLIMBING LANE | | |