

SECTION A-A

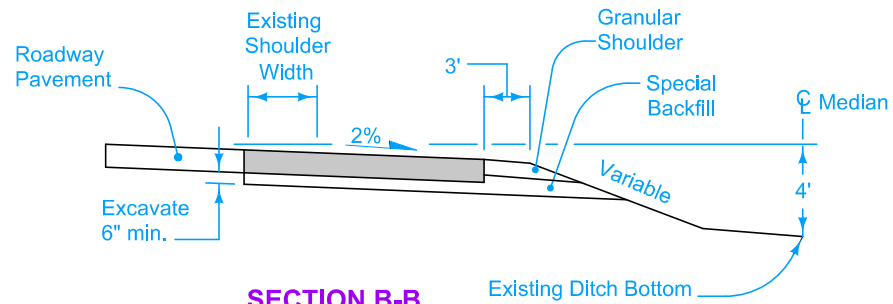

SECTION B-B

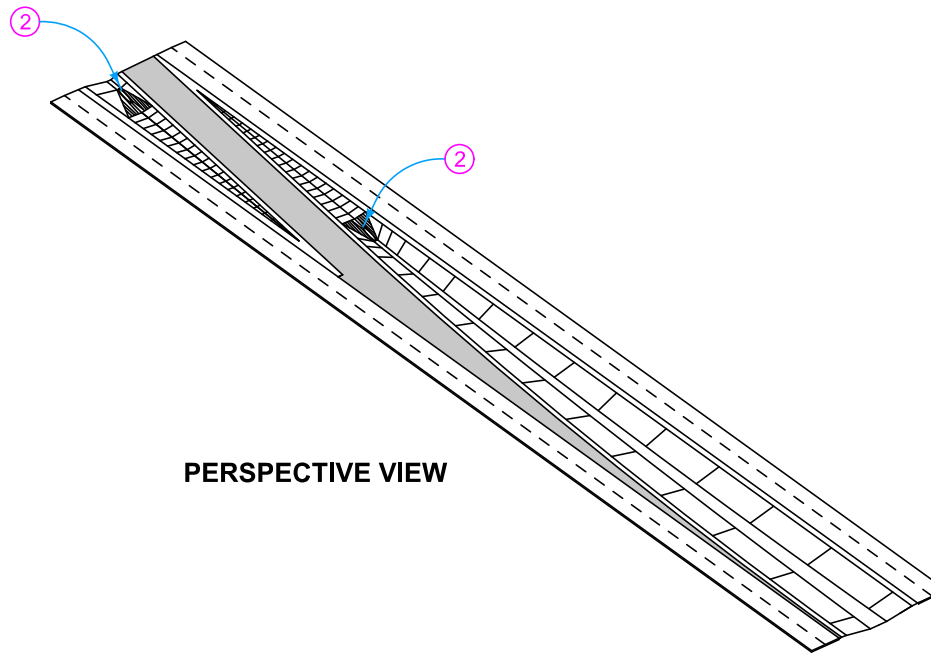

PERSPECTIVE VIEW

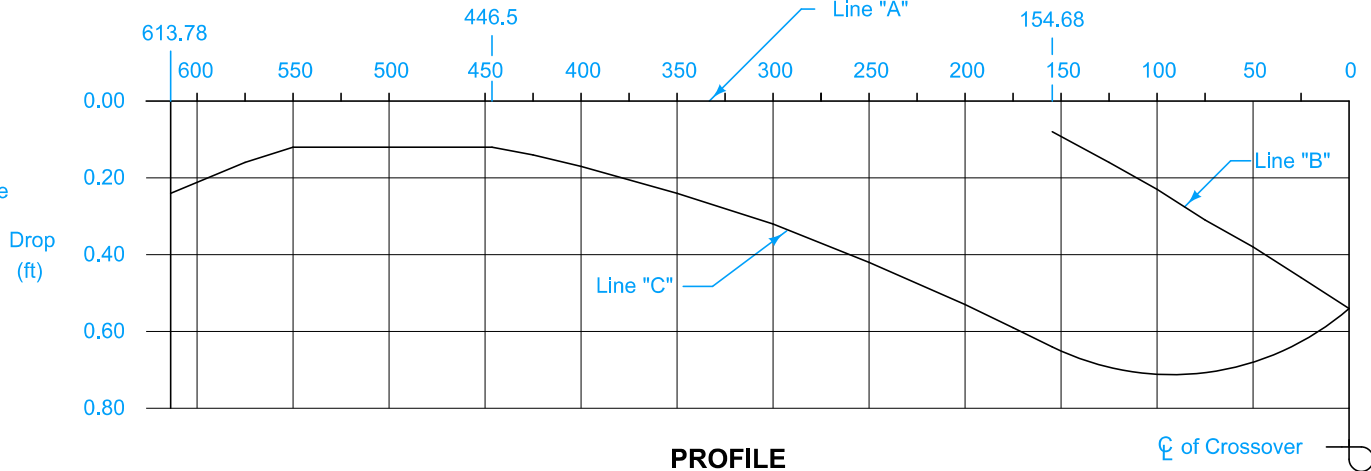

PROFILE

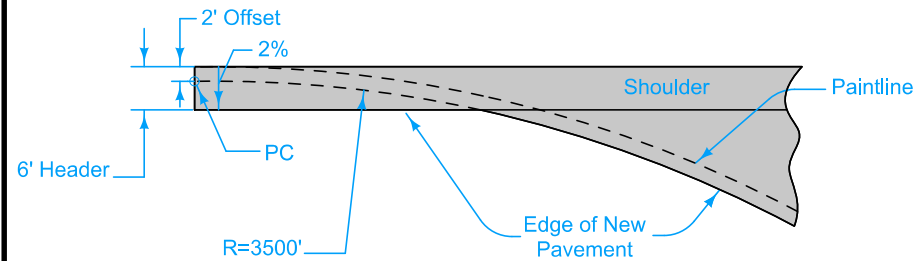

DETAIL 'A'

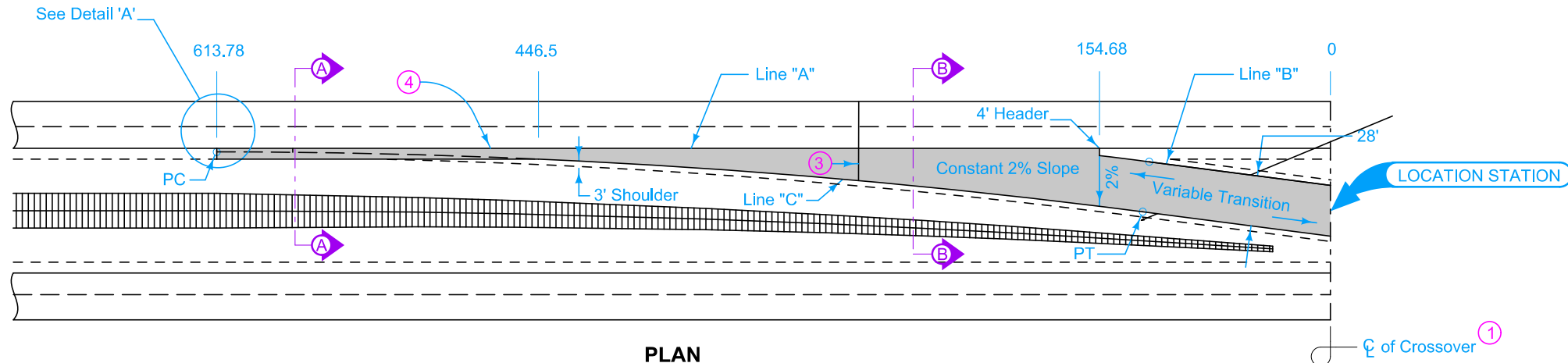

PLAN

Detour Pavement options: 9" PCC or 12" HMA

For joint details, see PV-101.

- ① Median crossover is symmetrical about centerline.
- ② Median pipe for crossover. See DR-504.
- ③ For PCC Detour Pavement, match existing roadway joints. 'CD' joints are required.
- ④ 'KT-2' or 'L-2' joint if mainline pavement is new construction. Bend bars out. 'BT-3' joint if mainline pavement is existing. 'B' joint if Detour Pavement is HMA.

DESIGN QUANTITY TABLE		
Detour Pavement Sq. Yds.	Special Backfill Tons	Granular Shoulder Tons
2305	985	*270

*Quantity based on 8" shoulder depth.



- Possible Contract Items:
- Detour Pavement
 - Embankment In Place
 - Excavation, Class 10, Roadway and Borrow
 - Excavation, Class 13, Roadway and Borrow
 - Granular Shoulder, Type A
 - Removal of Pavement
 - Special Backfill

Possible Tabulation:
112-8

TABLE OF OFFSETS AND DROPS																					
Distance (Feet)	613.78	575	550	525	500	475	446.5	425	400	350	300	250	200	175	154.68	125	100	75	50	25	0
Offset A to C (Feet)	6.00	6.00	6.00	6.00	6.00	6.00	6.00	7.10	8.53	11.95	16.09	20.96	26.55	29.61	32.24	36.30	39.92	43.70	47.52	51.34	55.16
Drop A to C (Feet)	0.24	0.16	0.12	0.12	0.12	0.12	0.12	0.14	0.17	0.24	0.32	0.42	0.53	0.59	0.64	0.69	0.71	0.71	0.68	0.63	0.54
Drop A to B (Feet)															0.08	0.16	0.23	0.31	0.38	0.46	0.54

REVISION	
1	04-21-20

STANDARD ROAD PLAN

PV-511

SHEET 1 of 1

REVISIONS: New logo and modified circle note 2.

Shawn Miller
APPROVED BY DESIGN METHODS ENGINEER

MEDIAN CROSSOVER (82' MEDIAN) 28' WIDE 2 LANE