

PILE BENT NOTES:

THESE PIER BENTS ARE DESIGNED FOR USE IN LOCATIONS WHERE ICE AND DRIFT CONDITIONS ARE NOT SEVERE.

FOR DETAILS OF TRESTLE PILES, TYPES 1, 2 AND 3, SEE STANDARD PIOL.

MINIMUM CLEAR DISTANCE FROM FACE OF CONCRETE TO NEAR REINFORCING BAR SHALL BE 2 INCHES UNLESS OTHERWISE NOTED OR SHOWN.

PIER PILES SHALL BE DRIVEN TO VALUES SHOWN IN DESIGN PLANS.

REINFORCING BAR LIST AND ESTIMATED QUANTITIES - PER PILE BENT

BAR	LENGTH	SHAPE	7 PILE BENT			8 PILE BENT			9 PILE BENT			10 PILE BENT			11 PILE BENT			12 PILE BENT			13 PILE BENT		
			NO.	SIZE	WEIGHT	NO.	SIZE	WEIGHT	NO.	SIZE	WEIGHT	NO.	SIZE	WEIGHT	NO.	SIZE	WEIGHT	NO.	SIZE	WEIGHT	NO.	SIZE	WEIGHT
a1	32'-8"		6	9	666	6	9	666	6	9	666	6	9	666	6	9	666	4	9	444	4	9	444
a2	32'-8"		4	8	349	4	8	349	4	8	349	4	8	349	4	8	349	4	8	349	4	8	349
b1	32'-8"		4	9	444	4	9	444	4	9	444	4	9	444	4	9	444	4	8	349	4	8	349
5c1	11'-10"		26	5	321	30	5	370	34	5	420	38	5	469	32	5	395	35	5	432	26	5	321
8e1	8'-2"		4	8	87	4	8	87	4	8	87	4	8	87	4	8	87	4	8	87	4	8	87
REINFORCING STEEL (LB.)			1867			1916			1966			2015			1941			1661			1550		
PILE TYPE																							
STRUCTURAL CONCRETE (CY)			1, 2			-----			11.5			11.4			11.4			11.3			11.3		
			3			11.9			11.9			11.9			11.9			11.9			-----		

BENT BAR DETAILS

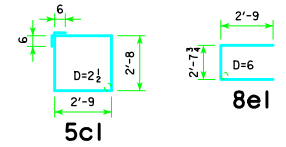

NOTE: ALL DIMENSIONS ARE OUT TO OUT. D=PIN DIAMETER.

℄-℄ ABUTMENT BEARING	FRICTION BEARING PILING			FRICTION OR POINT BEARING PILING		
	PIOL TYPE 1 OR 2			PIOL TYPE 3		
	NUMBER OF TRESTLE PILES	③ "K" (INCHES)	④ LRFD P _u STRENGTH I ₁ DES. LOAD (KIPS)	NUMBER OF TRESTLE PILES	PILE SIZE	④ LRFD P _u STRENGTH I ₁ DES. LOAD (KIPS)
138'-10"	10	14	95	7	HP10x57	135
	9	16	105	8	HP12x53	119
151'-4"	11	14	91	7	HP10x57	143
	10	16	100	8	HP12x53	125
163'-10"	---	---	---	8	HP10x57	135
	10	16	108	9	HP12x53	120
176'-4"	---	---	---	8	HP10x57	141
	---	---	---	9	HP12x53	126
188'-10"	---	---	---	9	HP10x57	131
	---	---	---	9	HP12x53	131
201'-4"	---	---	---	10	HP10x57	132
	---	---	---	10	HP12x53	132
213'-10"	---	---	---	10	HP10x57	138
	---	---	---	11	HP12x53	126
226'-4"	---	---	---	11	HP10x57	133
	---	---	---	11	HP12x53	133
243'-0"	---	---	---	11	HP10x57	139
	---	---	---	12	HP12x53	128

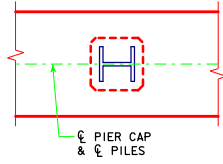

PILE ORIENTATION DETAIL FOR TYPE 3 TRESTLE BENT PILES

- ① SEE SHEET H30-17-06 FOR STEP REINFORCING STEEL QUANTITIES AND DETAILS.
- ② CONCRETE QUANTITIES SHOWN HAVE HAD THE VOLUME OF EMBEDDED PILES DEDUCTED FOR TYPES 1 AND 2 BASED ON 0.8 FT³ PER FOOT OF EMBEDMENT. THE CONCRETE QUANTITIES FOR TYPE 3 PILES DO NOT REQUIRE REDUCTION FOR PILE EMBEDMENT.
- ③ SEE STANDARD PIOL FOR "K" DIMENSION.
- ④ NOTE: P_u STRENGTH I DESIGN LOAD (KIPS) IS NOT THE VALUE USED IN THE FIELD FOR DRIVING PILES.

NOTE: FRICTION BEARING INCLUDES SIDE FRICTION AND END BEARING IN SOIL. POINT BEARING INCLUDES SIDE FRICTION AND POINT BEARING IN ROCK.

REVISED 04-13 - REVISION FOR LRFD PILE DESIGN.

LATEST REVISION DATE 04-13 APPROVED BY BRIDGE ENGINEER 	
	STANDARD DESIGN - 30' ROADWAY, THREE SPAN BRIDGES PRETENSIONED PRESTRESSED CONCRETE BEAM BRIDGES DECEMBER, 2006
	PILE BENT PIERS H30-49-06 15° SKEW