

REVISED 10-2016 - CHANGED DIAPHRAGM SPACING IN ZERO SKEW FRAMING PLAN (WAS 4 SPACED AT 22'-0") IN 88'-0" CENTER SPAN, CHANGED DIAPHRAGM SPACING IN SKEWED FRAMING PLAN (WAS 4 SPACED AT 22'-0") IN 88'-0" CENTER SPAN, ADDED DIAPHRAGMS TO SKEWED FRAMING PLAN IN OUTER BAYS, BETWEEN BEAMS 1 & 2 AND 5 & 6 OF 88'-0" CENTER SPAN, 11'-0" FROM PIER CENTERLINES.

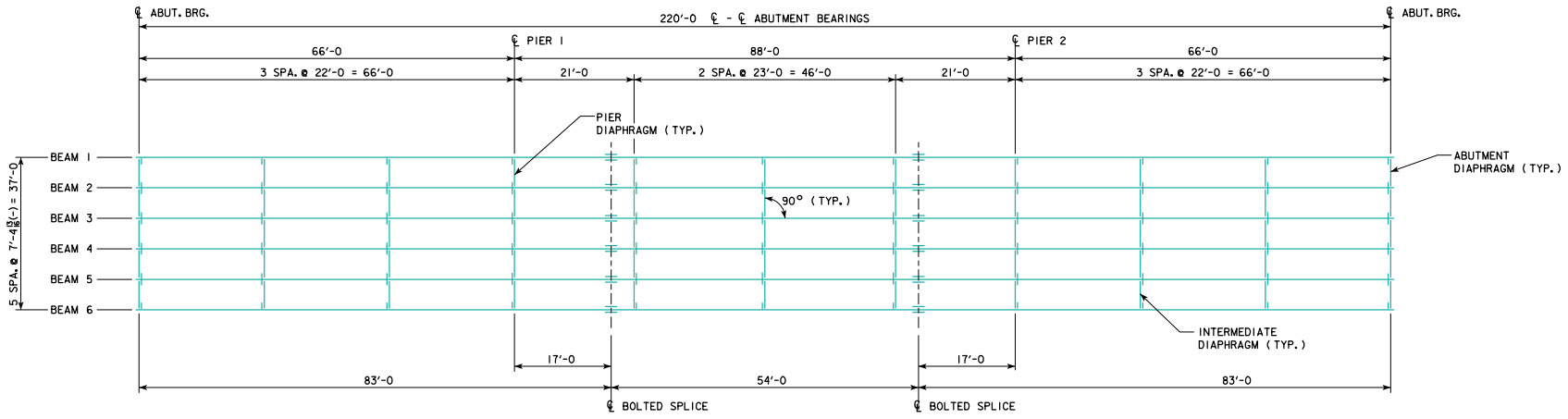

0° SKEW FRAMING PLAN

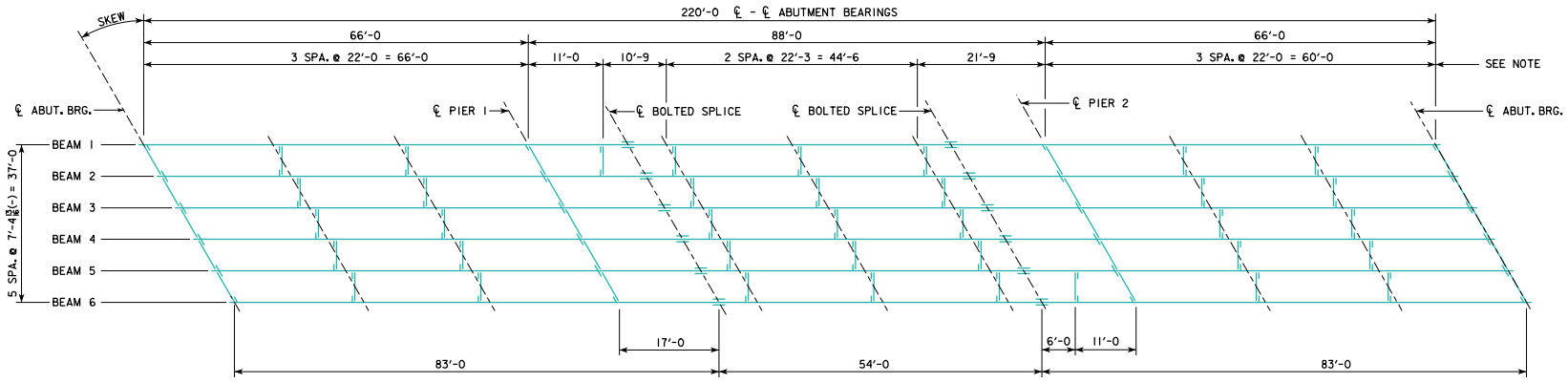

SKEWED FRAMING PLAN  
(R.A. SHOWN, L.A. SIMILAR)

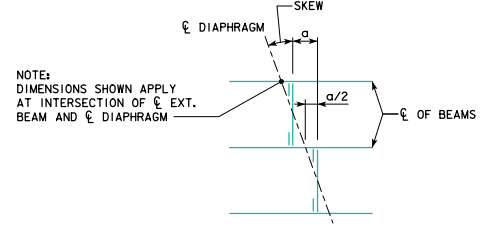

SKEW	a (FT.-IN.)
10°	1'-3 $\frac{11}{16}$ "
20°	2'-8 $\frac{5}{8}$ "
30°	4'-3 $\frac{1}{4}$ "

10-2016 LATEST REVISION DATE	 APPROVED BY BRIDGE ENGINEER	 STANDARD DESIGN - 40' ROADWAY, 3 SPAN BRIDGES <b>ROLLED STEEL BEAM BRIDGES</b> JUNE, 2010	<b>FRAMING PLAN</b> <b>220'-0 BRIDGE</b>	<b>RS40-047-10</b>