

REVISED 02-14 - A STUD HEIGHT OF 4" WAS ADDED TO THE * NOTE
 REVISED 10-2016 - ADDED 8 SHEAR STUDS AT EACH "CENTERLINE OF BOLTED SPLICE" LOCATION BETWEEN "ZONE A & B" AND "ZONE C & D". ADDED "SHEAR STUD ON SPLICE PLATE DETAILS"
 SHOWING 2 STUDS PER ROW.

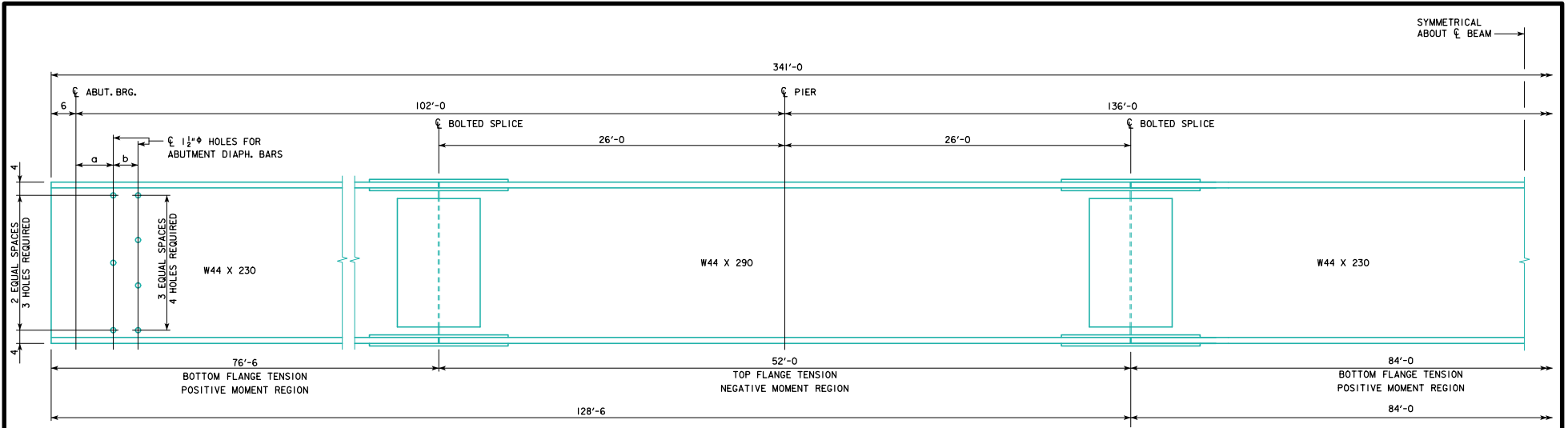

BEAM ELEVATION

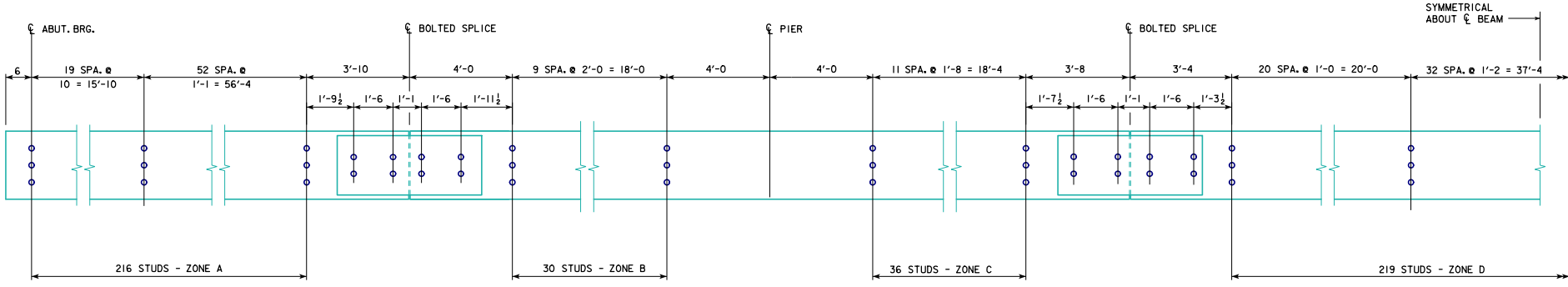

SHEAR STUD SPACING

* NOTE: STUD HEIGHTS (3 1/2", 4" OR 5") FOR THE LOCATIONS SHOWN SHALL BE DETERMINED BY THE DESIGNER. ON "MISCELLANEOUS DETAILS 340'-0 BRIDGE" SHEET, STUD HEIGHTS CAN BE IDENTIFIED BY THE DESIGNER IN A TABLE CORRESPONDING TO THE ZONES LISTED ON THIS SHEET.

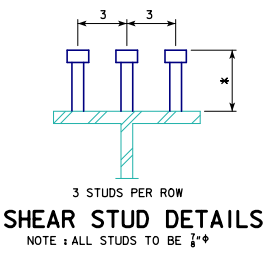
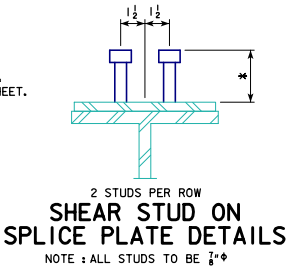

SKEW	a (IN)	b (IN)
0°	9	6
10°	9 1/8	6 1/8
20°	9 3/8	6 3/8
30°	10 1/8	6 7/8
45°	12 1/2	8 1/2

10-2016
 LATEST REVISION DATE
 APPROVED BY BRIDGE ENGINEER
Thomas E. McQuinn

IOWADOT Highway Division
 STANDARD DESIGN - 40' ROADWAY, 3 SPAN BRIDGES
ROLLED STEEL BEAM BRIDGES
 JUNE, 2010

BEAM PLAN AND ELEVATION
340'-0 BRIDGE RS40-080-10