

ENGLISHDESIGNEDTRIPLECULVERTS.DGN - TRRCB 12-5-20 - THIS SHEET ISSUED 07-2020.

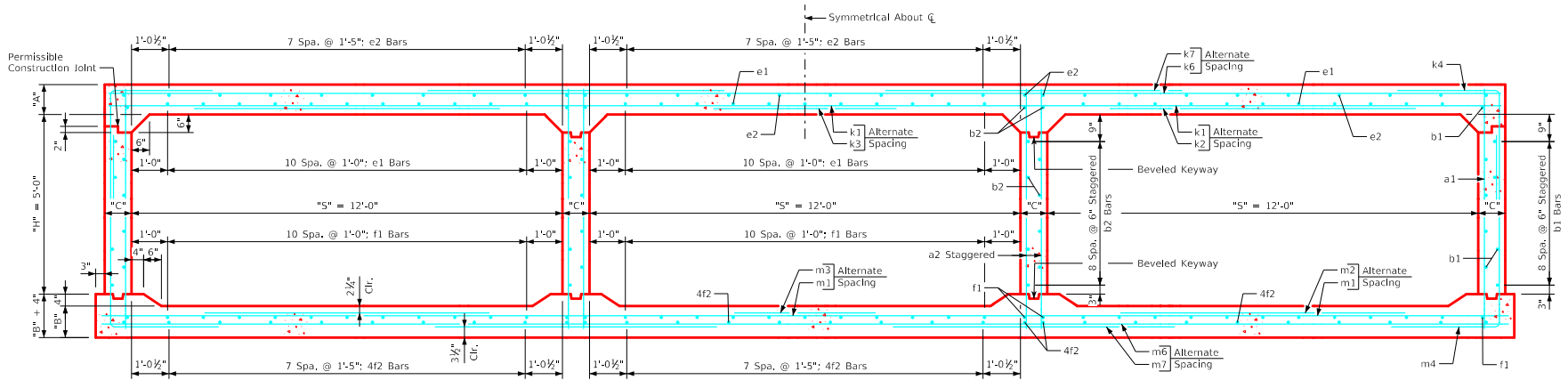

Triple 12' x 5' Barrel Section

Bent Bar Detail

Bars	D
4	3"
5	3 1/2"
6	4 1/2"
7	5 1/2"

Notes:
 1. Dimensions listed on this sheet to be used in conjunction with Sheet TRRCB G3-20.
 2. Fill, dimensions "k1" and "H" are in feet.
 3. Dimensions "A", "g", "C", "D", and "Sp." listed in the bar list are in inches.
 4. Dimensions "L", "H", "V" are in feet and inches.

Note: All dimensions are out to out. D = pin diameter.

Notes:

- Dimensions listed on this sheet to be used in conjunction with Sheet TRRCB G3-20.
- Fill, dimensions "k1" and "H" are in feet.
- Dimensions "A", "g", "C", "D", and "Sp." listed in the bar list are in inches.
- Dimensions "L", "H", "V" are in feet and inches.

Variable Dimensions and Quantities for Triple 12' x 5' Barrel Sections

Dimensions																		Bar List																		Concrete (CY/FT)			Steel (Lb/FT)																		
Fill	S	H	A	B	C	D	E	R	T	U	W	X	Z	a1	a2	b1	b2	e1	e2	f1	f2	k1	k2	k3	k4	k6	k7	Slab	Floor	Walls	Total	Steel																									
0	12	5	14	11.5	9	9	9	0'-0"	0'-0"	7'-3"	3'-2"	5'-2"	4'-4"	4	12	7'-0"	6	9	7'-0"	4	6	20	4	6	22	4	12	33	4	17	30	4	12	39	4	17	30	6	18	38'-8"	6	18	12'-11"	4	18	12'-9"	6	12	7'-2"	3'-2"	4'-0"	5	18	38'-8"	6	18	14'-5"
1	12	5	13	11	9	9	9	0'-9"	0'-3"	6'-10"	2'-10"	4'-4"	4'-3"	4	12	6'-11"	6	9	6'-11"	4	6	20	4	6	22	4	12	33	4	17	30	4	12	39	4	17	30	6	18	38'-8"	6	18	12'-8"	4	18	11'-3"	6	12	7'-2"	3'-3"	3'-11"	5	18	38'-8"	6	18	13'-9"
2	12	5	10	10	9	9	9	1'-9"	1'-7"	5'-9"	3'-8"	5'-2"	4'-3"	4	9	6'-7"	7	9	6'-7"	4	6	20	4	6	22	4	12	33	4	17	30	4	12	39	4	17	30	7	18	38'-8"	6	18	11'-0"	5	18	9'-3"	6	9	7'-4"	3'-8"	3'-8"	5	18	38'-8"	8	18	13'-9"
3-6	12	5	9	10	9	9	9	3'-8"	2'-7"	4'-7"	3'-5"	5'-2"	4'-0"	4	9	6'-6"	5	6	6'-6"	4	6	20	4	6	22	4	12	33	4	17	30	4	12	39	4	17	30	5	9	38'-8"	4	9	8'-10"	4	9	5'-5"	6	9	7'-2"	3'-7"	3'-7"	5	9	38'-8"	5	9	8'-10"
7-8	12	5	10	11	9	9	9	3'-0"	2'-2"	3'-11"	3'-2"	5'-2"	3'-10"	4	9	6'-8"	6	9	6'-8"	4	6	20	4	6	22	4	12	33	4	17	30	4	12	39	4	17	30	5	12	38'-8"	5	12	9'-8"	4	12	6'-9"	6	9	6'-6"	2'-10"	3'-8"	5	9	38'-8"	5	9	8'-2"
9-10	12	5	11	12.5	9	9	9	5'-2"	2'-10"	3'-10"	2'-10"	5'-2"	3'-10"	4	12	6'-10"	6	9	6'-10"	4	6	20	4	6	22	4	12	33	4	17	30	4	12	39	4	17	30	5	9	38'-8"	4	9	8'-7"	4	9	2'-5"	5	6	5'-10"	2'-6"	3'-4"	4	9	38'-8"	6	9	8'-0"
11-12	12	5	12	13.5	9	9	9	5'-2"	2'-7"	3'-10"	2'-8"	5'-2"	3'-10"	4	12	7'-0"	6	9	7'-0"	4	6	20	4	6	22	4	12	33	4	17	30	4	12	39	4	17	30	5	9	38'-8"	4	9	9'-2"	4	9	2'-5"	5	6	5'-10"	2'-5"	3'-5"	5	12	38'-8"	7	12	8'-1"
13-15	12	5	13.5	15.5	9	9	9	4'-1"	2'-5"	3'-10"	2'-3"	4'-2"	3'-10"	4	6	7'-4"	6	9	7'-4"	4	6	20	4	6	22	4	12	33	4	17	30	4	12	39	4	17	30	6	12	38'-8"	5	12	10'-0"	4	12	4'-7"	4	6	5'-7"	2'-5"	3'-2"	5	12	38'-8"	7	12	8'-2"
16-17	12	5	14.5	16.5	9	9	9	4'-0"	1'-10"	3'-10"	2'-0"	4'-1"	3'-10"	5	12	7'-6"	6	9	7'-6"	4	6	20	4	6	22	4	12	33	4	17	30	4	12	39	4	17	30	7	18	38'-8"	7	18	11'-1"	4	18	4'-9"	4	6	5'-8"	2'-5"	3'-3"	5	9	38'-8"	6	9	8'-3"
18-19	12	5	15.5	17.5	9	9	9	3'-11"	1'-9"	3'-11"	1'-10"	4'-9"	3'-11"	4	9	7'-8"	6	9	7'-8"	4	6	20	4	6	22	4	12	33	4	17	30	4	12	39	4	17	30	7	18	38'-8"	7	18	11'-2"	4	18	4'-11"	4	6	5'-9"	2'-5"	3'-4"	5	9	38'-8"	6	9	8'-5"
20-21	12	5	17	18.5	9	9	9	4'-0"	1'-2"	4'-0"	1'-5"	4'-9"	4'-0"	4	9	7'-10"	6	9	7'-10"	4	6	20	4	6	22	4	12	33	4	17	30	4	12	39	4	17	30	7	18	38'-8"	7	18	11'-9"	4	18	4'-9"	4	6	5'-11"	2'-6"	3'-5"	5	9	38'-8"	6	9	8'-8"
22-23	12	5	18	20	9	9	9	4'-2"	1'-1"	4'-0"	1'-2"	4'-9"	4'-1"	4	12	8'-1"	6	9	8'-1"	4	6	20	4	6	22	4	12	33	4	17	30	4	12	39	4	17	30	5	9	38'-8"	5	9	11'-10"	4	9	4'-5"	4	6	6'-2"	2'-7"	3'-7"	5	9	38'-8"	6	9	8'-9"
24-25	12	5	19.5	21.5	9	9	9	4'-1"	0'-11"	4'-1"	1'-0"	4'-9"	4'-2"	4	12	8'-4"	6	9	8'-4"	4	6	20	4	6	22	4	12	33	4	17	30	5	12	39	4	17	30	5	9	38'-8"	5	9	12'-0"	4	9	4'-7"	4	6	6'-4"	2'-8"	3'-8"	5	9	38'-8"	6	9	9'-0"

LATEST REVISION DATE

APPROVED BY BRIDGE ENGINEER

Standard Design
Triple Reinforced Concrete Box Culverts
 July, 2020

Culvert Barrel Details
 12' x 5' Barrel Sections

TRRCB 12-5-20