

REVISED 10-2016 - CHANGED DIAPHRAGM SPACING IN SKEWED FRAMING PLAN (WAS 4 SPACED AT 20'-0" IN 80'-0" CENTER SPAN, ADDED DIAPHRAGMS TO SKEWED FRAMING PLAN IN OUTER BAYS, BETWEEN BEAMS 1 & 2 AND 5 & 6 OF 80'-0" CENTER SPAN, 10'-0" FROM PIER CENTERLINES.

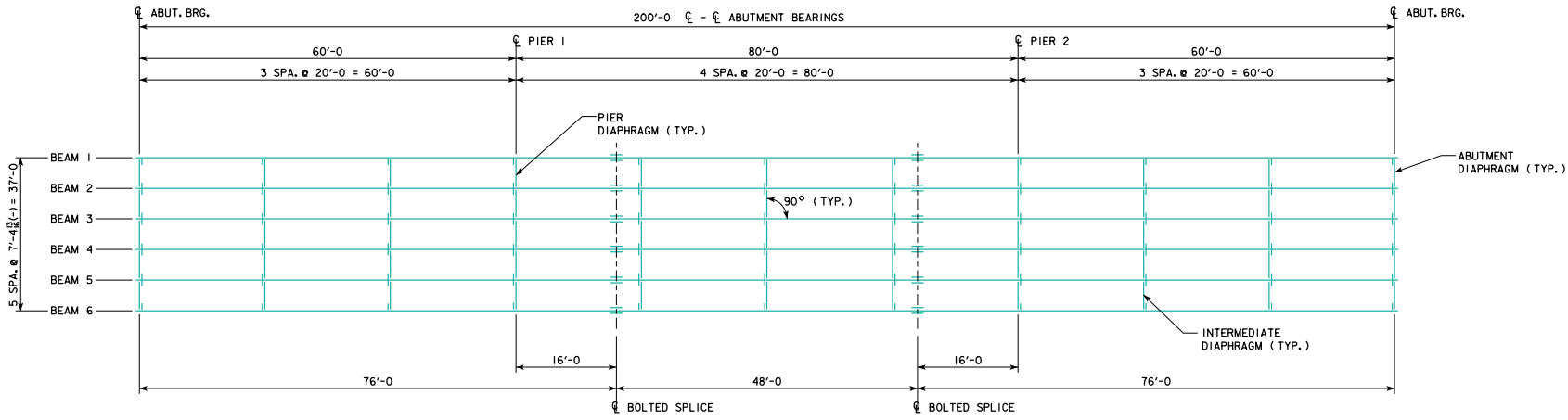

0° SKEW FRAMING PLAN

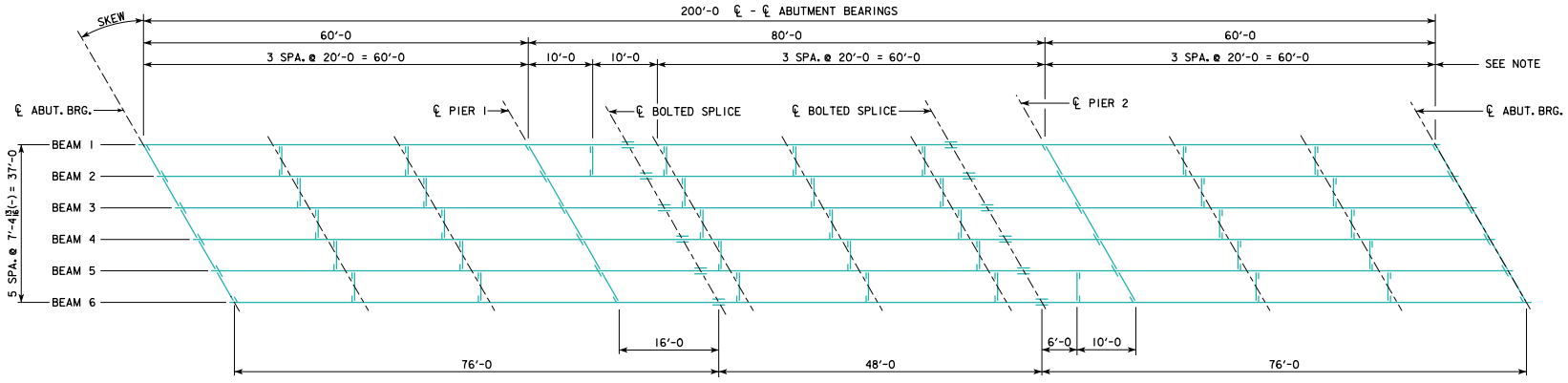

SKEWED FRAMING PLAN
(R.A. SHOWN, L.A. SIMILAR)

NOTE:
DIMENSIONS SHOWN APPLY
AT INTERSECTION OF EXT.
BEAM AND DIAPHRAGM

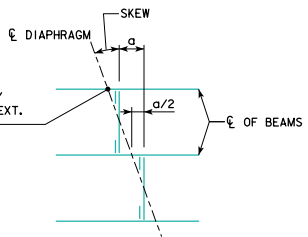

SKEW	a (FT.-IN.)
10°	1'-3 ¹¹ / ₁₆ "
20°	2'-8 ¹ / ₁₆ "
30°	4'-3 ¹ / ₄ "

10-2016
LATEST REVISION DATE

APPROVED BY BRIDGE ENGINEER



STANDARD DESIGN - 40' ROADWAY, 3 SPAN BRIDGES
ROLLED STEEL BEAM BRIDGES
 JUNE, 2010

FRAMING PLAN
200'-0 BRIDGE

RS40-045-10