

REVISED 02-14 - A STUD HEIGHT OF 4" WAS ADDED TO THE * NOTE.

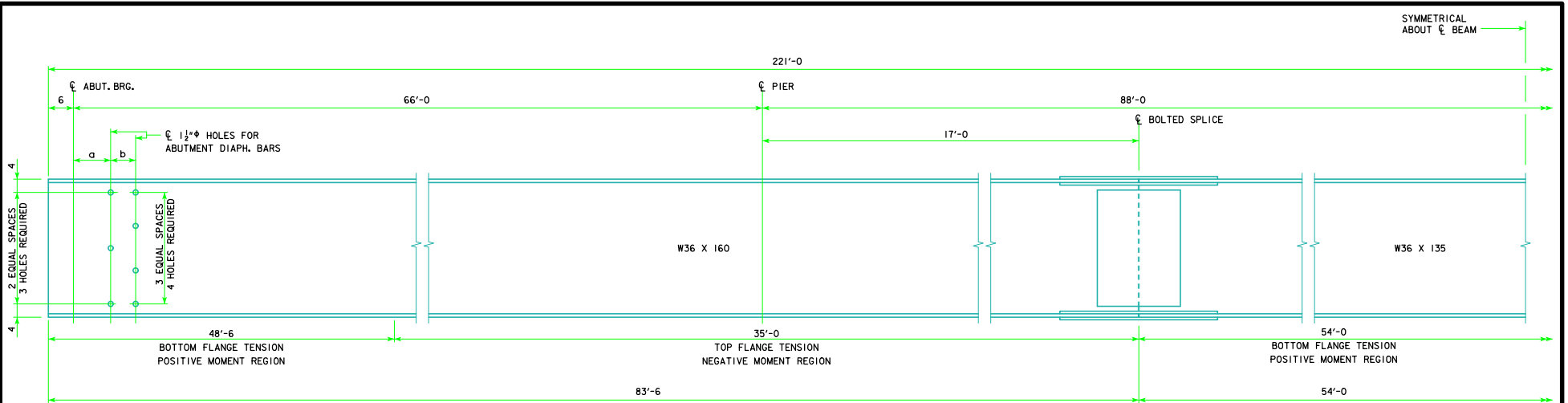

BEAM ELEVATION

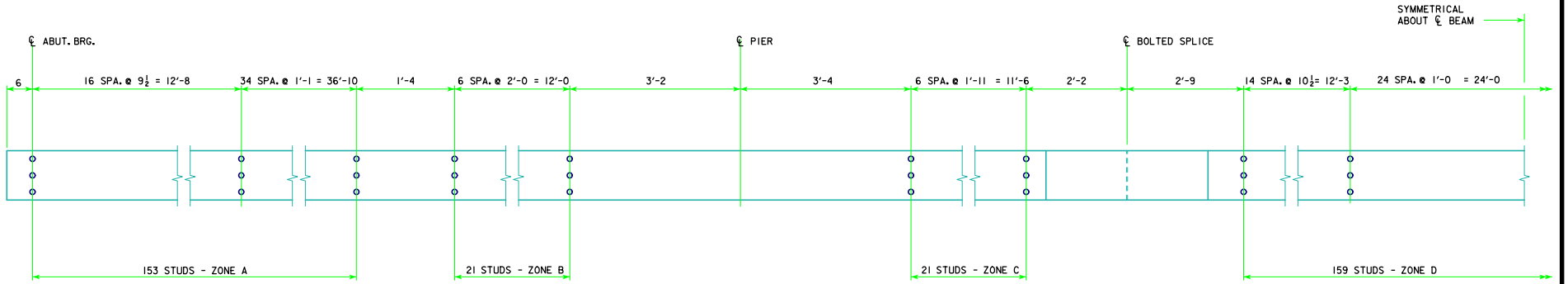

SHEAR STUD SPACING

* NOTE: STUD HEIGHTS (3 1/2", 4" OR 5") FOR THE LOCATIONS SHOWN SHALL BE DETERMINED BY THE DESIGNER. ON "MISCELLANEOUS DETAILS 220'-0 BRIDGE" SHEET, STUD HEIGHTS CAN BE IDENTIFIED BY THE DESIGNER IN A TABLE CORRESPONDING TO THE ZONES LISTED ON THIS SHEET.

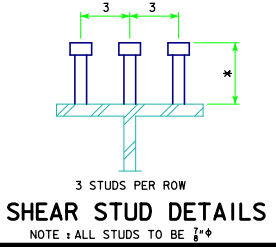

SKEW	a (IN)	b (IN)
0°	9	6
10°	9 1/4	6 1/4
20°	9 1/2	6 1/2
30°	10 1/4	6 3/4
45°	12 1/4	8 1/4

LATEST REVISION DATE 02-14	APPROVED BY BRIDGE ENGINEER 	<p>ROLLED STEEL BEAM BRIDGES</p> <p>STANDARD DESIGN - 40' ROADWAY, 3 SPAN BRIDGES</p> <p>JUNE, 2010</p>
BEAM PLAN AND ELEVATION 220'-0 BRIDGE		RS40-074-10