

### Variable Dimensions and Quantities for Triple 10' x 11' Barrel Sections

Dimensions														Bar List																																											
Fill	S	H	A	B	C	D	E	R	T	U	W	X	Z	a1			a2			b1			b2			e1			e2			f1			f2			k1			k2			k3			k4			k6			k7				
														Size	Sp.	L	Size	Sp.	L	Size	Sp.	No.	Size	Sp.	No.	Size	Sp.	No.	Size	Sp.	No.	Size	Sp.	No.	Size	Sp.	No.	Size	Sp.	No.	Size	Sp.	No.	Size	Sp.	No.	Size	Sp.	L	Size	Sp.	L	Size	Sp.	L		
0	10	11	13	11	11	9	9	0'-0	0'-0	6'-3	2'-5	3'-8	4'-0	4	12	12'-11	7	9	12'-11	4	6	44	4	6	46	4	12	27	4	18	24	4	12	33	4	18	24	6	18	33'-4	5	18	10'-11	4	18	10'-11	6	9	10'-6	6'-7	3'-11	4	12	33'-4	4	12	12'-6
1	10	11	12.5	11	11	9	9	0'-10	0'-3	6'-3	2'-5	3'-8	3'-8	4	12	12'-10	7	9	12'-10	4	6	44	4	6	46	4	12	27	4	18	24	4	12	33	4	18	24	6	18	33'-4	5	18	10'-11	4	18	10'-11	6	9	10'-6	6'-7	3'-11	4	12	33'-4	4	12	12'-6
2	10	11	9	10	11	9	9	1'-3	0'-11	6'-10	2'-2	4'-3	3'-8	4	9	12'-6	7	9	12'-6	4	6	44	4	6	46	4	12	27	4	18	24	4	12	33	4	18	24	5	12	33'-4	5	12	10'-1	5	12	8'-5	6	9	10'-4	6'-9	3'-7	5	18	33'-4	7	18	13'-8
3-6	10	11	8	10	11	9	9	2'-0	1'-8	4'-2	2'-2	3'-4	3'-9	4	9	12'-5	7	9	12'-5	4	6	44	4	6	46	4	12	27	4	18	24	4	12	33	4	18	24	5	12	33'-4	5	12	8'-4	5	12	6'-11	6	9	8'-7	5'-1	3'-6	5	12	33'-4	5	12	8'-8
7-8	10	11	8	10	11	9	9	2'-10	2'-3	3'-6	3'-1	4'-3	3'-6	4	12	12'-5	7	9	12'-5	4	6	44	4	6	46	4	12	27	4	18	24	4	12	33	4	18	24	5	12	33'-4	5	12	7'-5	4	12	5'-3	5	6	7'-1	4'-0	3'-1	5	12	33'-4	6	12	7'-1
9-10	10	11	8.5	11	11	9	9	2'-9	2'-2	3'-5	2'-9	4'-3	3'-6	5	12	12'-6	7	9	12'-6	4	6	44	4	6	46	4	12	27	4	18	24	4	12	33	4	18	24	5	12	33'-4	5	12	7'-7	4	12	5'-5	5	6	7'-1	3'-11	3'-2	5	12	33'-4	6	12	6'-11
11-12	10	11	9.5	12	11	9	9	3'-0	2'-1	3'-5	2'-6	4'-3	3'-4	5	12	12'-8	7	9	12'-8	4	6	44	4	6	46	4	12	27	4	18	24	4	12	33	4	18	24	5	12	33'-4	5	12	7'-10	4	12	4'-11	5	6	7'-2	3'-11	3'-3	5	12	33'-4	6	12	6'-11
13-15	10	11	11.5	14	11	6	9	3'-0	1'-11	3'-4	2'-3	4'-3	3'-6	4	6	13'-0	7	9	13'-0	4	6	44	4	6	46	4	12	27	4	18	24	4	12	33	4	18	24	5	12	33'-4	5	12	8'-6	4	12	4'-11	6	9	8'-2	4'-1	4'-1	5	12	33'-4	6	12	6'-11
16-17	10	11	12	14.5	11.5	9	9	4'-3	2'-3	3'-5	2'-1	4'-3	3'-5	6	12	13'-1	7	9	13'-1	4	6	44	4	6	46	4	12	27	4	18	24	4	12	33	4	18	24	5	9	33'-6	4	9	7'-8	4	9	2'-6	6	9	8'-0	4'-0	4'-0	4	12	33'-6	7	12	7'-1
18-19	10	11	13	15.5	12.5	6	9	4'-3	2'-1	3'-5	1'-11	3'-11	3'-6	4	6	13'-3	7	9	13'-3	4	6	44	4	6	46	4	12	27	4	18	24	4	12	33	4	18	24	5	9	33'-10	4	9	8'-1	4	9	2'-6	5	6	7'-7	4'-1	3'-6	5	12	33'-10	6	12	7'-1
20-21	10	11	14	16.5	13	9	6	4'-4	1'-10	3'-6	1'-9	3'-11	3'-7	6	9	13'-5	6	6	13'-5	4	6	44	4	6	46	4	12	27	4	18	24	4	12	33	4	18	24	5	9	34'-0	4	9	8'-10	4	9	2'-5	6	9	8'-2	4'-1	4'-1	5	12	34'-0	6	12	7'-3
22-23	10	11	15	17.5	13.5	9	6	4'-3	1'-8	3'-6	1'-6	3'-4	3'-8	6	9	13'-7	6	6	13'-7	4	6	44	4	6	46	4	12	27	4	18	24	4	12	33	4	18	24	5	9	34'-2	4	9	9'-3	4	9	2'-8	5	6	7'-10	4'-2	3'-8	5	12	34'-2	6	12	7'-4
24-25	10	11	16	18.5	14	9	9	3'-8	1'-5	3'-7	1'-4	3'-3	3'-9	6	9	13'-9	8	9	13'-9	4	6	44	4	6	46	4	12	27	4	18	24	4	12	33	4	18	24	5	9	34'-4	4	9	9'-9	4	9	3'-10	5	6	8'-0	4'-3	3'-9	5	12	34'-4	6	12	7'-6

Fill	Bar List												Quantities																		
	k9	L	m1	L	m2	L	m3	L	m4	H	V	m6	L	m7	L	m9	L	Slab	Floor	Walls	Total	Steel (LB/FT)									
0	4	4.5	33'-4	5	12	33'-10	4	12	7'-3	4	12	3'-7	6	9	20'-11	9'-7	11'-4	5	18	33'-10	7	18	7'-11	7	4.5	33'-10	1.443	1.247	1.437	4.127	549.13
1	4	4.5	33'-4	5	12	33'-10	4	12	7'-3	4	12	3'-7	6	9	17'-10	6'-6	11'-4	4	9	33'-10	4	9	7'-4	4	4.5	33'-10	1.391	1.247	1.437	4.075	527.55
2	7	4.5	33'-4	5	12	33'-10	5	12	7'-8	4	12	2'-5	6	9	16'-5	5'-2	11'-3	4	12	33'-10	6	12	7'-5	6	4.5	33'-10	1.028	1.141	1.437	3.606	568.45
3-6	5	4.5	33'-4	5	12	33'-10	5	12	7'-7	4	12	4'-3	6	9	15'-11	4'-8	11'-3	4	9	33'-10	5	9	7'-6	7	4.5	33'-10	0.924	1.141	1.437	3.502	551.50
7-8	6	4.5	33'-4	5	9	33'-10	4	9	5'-10	4	9	2'-5	6	6	15'-4	4'-1	11'-3	4	12	33'-10	7	12	7'-1	7	4.5	33'-10	0.924	1.141	1.437	3.502	572.05
9-10	6	4.5	33'-4	5	9	33'-10	4	9	6'-6	4	9	2'-5	5	6	15'-3	3'-11	11'-4	4	12	33'-10	7	12	7'-1	7	4.5	33'-10	0.976	1.247	1.437	3.660	554.42
11-12	6	4.5	33'-4	5	9	33'-10	4	9	7'-2	4	9	2'-5	5	6	15'-5	4'-0	11'-5	5	12	33'-10	6	12	6'-9	6	4.5	33'-10	1.080	1.352	1.437	3.869	560.26
13-15	6	4.5	33'-4	5	9	33'-10	4	9	8'-0	4	9	2'-5	6	9	15'-9	4'-2	11'-7	5	18	33'-10	8	18	7'-3	8	4.5	33'-10	1.287	1.563	1.437	4.287	575.42
16-17	7	4.5	33'-6	5	9	34'-0	4	9	8'-4	4	9	2'-6	6	9	15'-9	4'-1	11'-8	5	12	34'-0	6	12	7'-1	6	4.5	34'-0	1.348	1.625	1.502	4.475	588.61
18-19	6	4.5	33'-10	5	9	34'-4	4	9	8'-8	4	9	3'-2	5	6	15'-11	4'-2	11'-9	5	12	34'-4	6	12	7'-3	6	4.5	34'-4	1.472	1.751	1.632	4.855	591.50
20-21	6	4.5	34'-0	6	12	34'-6	5	12	8'-11	4	12	3'-3	6	9	16'-0	4'-2	11'-10	5	12	34'-6	6	12	7'-5	6	4.5	34'-6	1.587	1.869	1.697	5.153	631.08
22-23	6	4.5	34'-2	6	12	34'-8	5	12	9'-5	4	12	4'-6	5	6	16'-2	4'-3	11'-11	5	12	34'-8	6	12	7'-7	6	4.5	34'-8	1.704	1.987	1.763	5.454	637.34
24-25	6	4.5	34'-4	6	12	34'-10	5	12	10'-1	4	12	4'-8	5	6	16'-4	4'-4	12'-0	5	12	34'-10	6	12	7'-10	6	4.5	34'-10	1.821	2.107	1.828	5.756	661.66

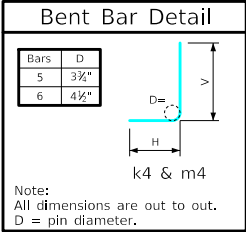

- Notes:
- Dimensions listed on this sheet to be used in conjunction with Sheet TRRCB G3-20.
  - Fill dimensions "S" and "H" are in feet.
  - Dimensions "A", "B", "C", "D", and "Sp." listed in the bar list are in inches.
  - Dimensions "L", "H", "V" are in feet and inches.

LATEST REVISION DATE	 APPROVED BY BRIDGE ENGINEER	
		Standard Design <b>Triple Reinforced Concrete                  Box Culverts</b> July, 2020
		<div style="text-align: center;"> <b>Culvert Barrel                  Details</b>                  10' x 11' Barrel Sections             </div> <div style="text-align: center;"> <b>TRRCB                  10-11-20</b>                  Sheet 2 of 2             </div>

ENGLISHLRFDDESIGNEDTRIPLECULVERTS.DGN - TRRCB 10-11&amp;2-20 - THIS SHEET ISSUED 07-2020.