

REVISED 07-2017: MODIFIED NOTES. CHANGED CALLOUT "SIMILAR TO DETAIL A" TO CONFORM TO CHANGE OF DETAIL D ON SOST-08-11. REFERENCE TO DETAIL D WAS REMOVED.
 PREVIOUS EDITIONS: 03-2016: UPDATED BRIDGE ENGINEER SIGNATURE.
 03-2015: UPDATED BRIDGE ENGINEER SIGNATURE.
 STEEL OVERHEAD SIGN TRUSS.DGN - SOST-05-11 - THIS SHEET ISSUED 09-2011.

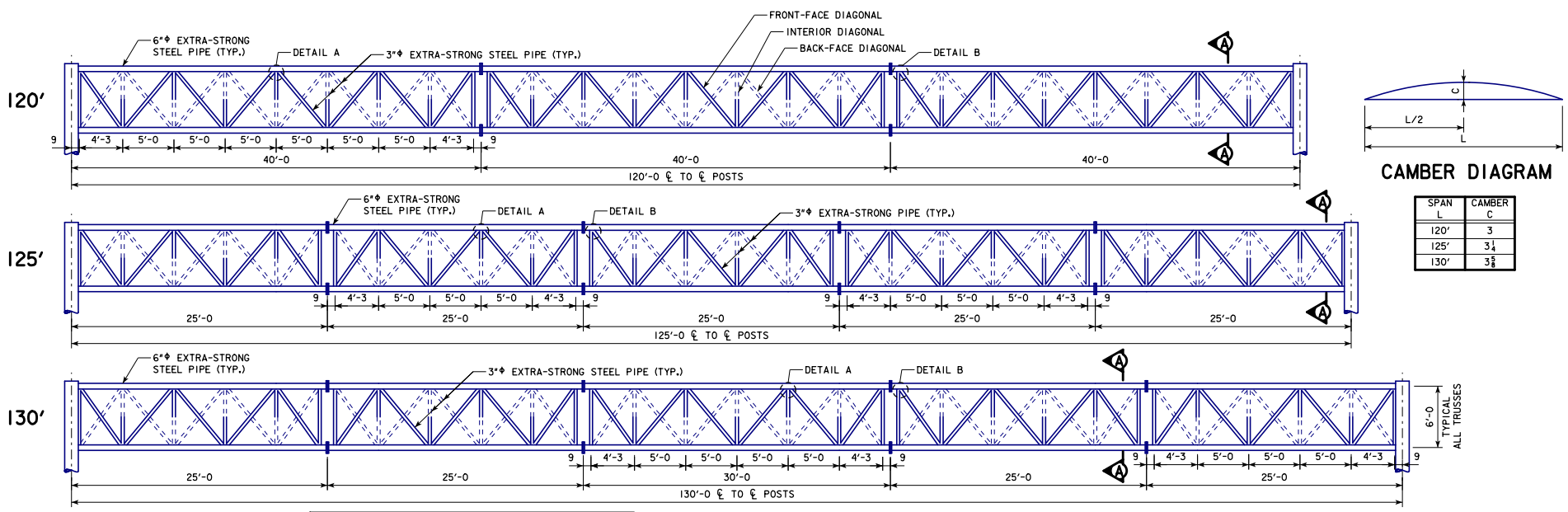

CAMBER DIAGRAM

SPAN L	CAMBER C
120'	3
125'	3 1/4
130'	3 1/2

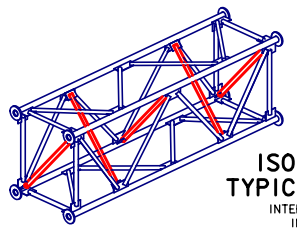

**ISOMETRIC VIEW
TYPICAL TRUSS UNIT**
INTERIOR DIAGONALS SHOWN IN RED FOR CLARITY

BACK-FACE DIAGONALS AND BOTTOM-FACE DIAGONALS ARE SHOWN WITH DASHED LINES. INTERIOR DIAGONALS ARE SHOWN SOLID NEAR THE FRONT FACE AND TOP FACE. INTERIOR DIAGONALS ARE SHOWN DASHED TOWARDS THE BACK FACE AND BOTTOM FACE.

PART ELEVATION VIEWS
GUSSET PLATES NOT SHOWN

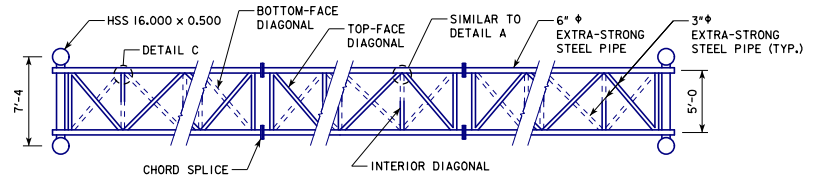

PART TOP VIEW
INTERIOR DIAGONALS HAVE SAME ORIENTATION AT CHORD SPLICE LOCATIONS

ALLOWABLE SIGN AREA

CENTERED				
SPAN	MAX. SIGN HEIGHT	MIN. END DIST.		MAX. SIGN AREA
L	H	E		A
120'	19'-0"	35'-0"		950 S.F.
125'	19'-0"	37'-6"		950 S.F.
130'	19'-0"	40'-0"		950 S.F.
120'	14'-9"	28'-0"		944 S.F.
125'	14'-9"	30'-6"		944 S.F.
130'	14'-9"	33'-0"		944 S.F.
120'	12'-0"	20'-6"		948 S.F.
125'	12'-0"	23'-0"		948 S.F.
130'	12'-0"	25'-6"		948 S.F.

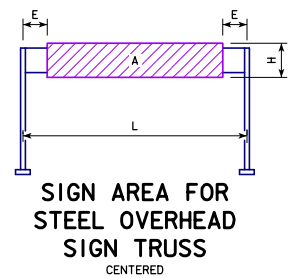

**SIGN AREA FOR
STEEL OVERHEAD
SIGN TRUSS**
CENTERED

ALLOWABLE SIGN AREA

OFFSET				
SPAN	MAX. SIGN HEIGHT	MIN. LEFT END DIST.	MIN. RIGHT END DIST.	MAX. SIGN AREA
L	H	E ₁	E ₂	A
120'	19'-0"	10'-0"	79'-0"	589 S.F.
120'	19'-0"	20'-0"	64'-0"	684 S.F.
125'	19'-0"	10'-0"	84'-0"	589 S.F.
125'	19'-0"	20'-0"	70'-0"	665 S.F.
130'	19'-0"	10'-0"	90'-0"	570 S.F.
130'	19'-0"	20'-0"	75'-0"	665 S.F.
120'	14'-9"	10'-0"	67'-0"	634 S.F.
120'	14'-9"	20'-0"	48'-0"	767 S.F.
125'	14'-9"	10'-0"	72'-0"	634 S.F.
125'	14'-9"	20'-0"	55'-0"	738 S.F.
130'	14'-9"	10'-0"	78'-0"	620 S.F.
130'	14'-9"	20'-0"	62'-0"	708 S.F.
120'	12'-0"	10'-0"	51'-0"	708 S.F.
120'	12'-0"	20'-0"	23'-0"	924 S.F.
125'	12'-0"	10'-0"	58'-0"	684 S.F.
125'	12'-0"	20'-0"	34'-0"	852 S.F.
130'	12'-0"	10'-0"	65'-0"	660 S.F.
130'	12'-0"	20'-0"	43'-0"	804 S.F.

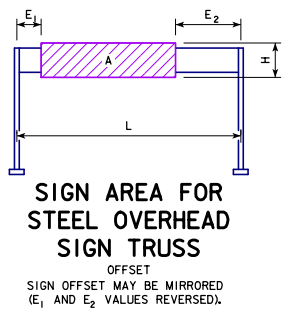

**SIGN AREA FOR
STEEL OVERHEAD
SIGN TRUSS**
OFFSET
SIGN OFFSET MAY BE MIRRORED (E₁ AND E₂ VALUES REVERSED).

SEE STANDARD SHEET SOST-08-11 FOR SECTION A-A AND DETAILS A, B AND C.

03-2019 LATEST REVISION DATE APPROVED BY BRIDGE ENGINEER	 STANDARD DESIGN STEEL OVERHEAD SIGN TRUSS SEPTEMBER, 2011	
	ELEVATION VIEWS FOR TRUSS SPANS 120'-130' SPANS	SOST-05-11