

PLAN VIEW
(RA-42 EXTENSION AND RA-41 INTAKE)

Extension unit may be used on either or both sides of intakes. Details are similar when extension unit is on the opposite side.

Dimensions shown are for the construction of a 150 millimeter standard curb as a part of pavement. Modifications may be made to conform to other curb shapes.

Contract Item:
Intake Extension Unit, RA-42

① The location station is where the centerline of intake meets the back of curb line.

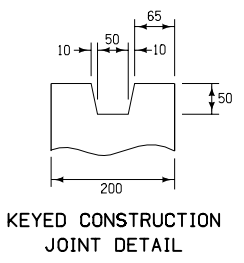

Placing sequence: 1. Base; 2. Walls and Extension; 3. Top; 4. Insert

REINFORCING BAR LIST							
BAR	SIZE	LOCATION	SHAPE	NO.	LENGTH	MASS	SPACING
b2	15	Intake Wall		3	760	4 kg	160
f1	15	Bottom		3	1450	7 kg	160
f2	15	Bottom		4	480	3 kg	460
g1	15	Wall		5	Varies*	3 kg	315
g2	15	Wall		1	1450	3 kg	-
g3	15	Top		4	Varies**	7 kg	460
g4	15	Top		3	1950	9 kg	-
					Total	36 kg	

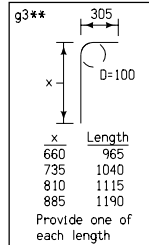
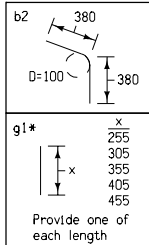

All dimensions given in millimeters unless noted.

METRIC VERSION		
	STANDARD ROAD PLAN RA-42(1)	
	<small>REVISION: Change 'E' Joint to 'ED' Joint and remove notes covered in the Specifications Book.</small>	<small>REVISION NO. 3</small>
	<small>APPROVED BY DESIGN METHODS ENGINEER</small>	<small>REVISION DATE 04-19-05</small>
INTAKE EXTENSION UNIT (FOR STANDARD RA-41 INTAKE) <small>(SHEET 1 OF 3)</small>		