

PART SECTION A-A

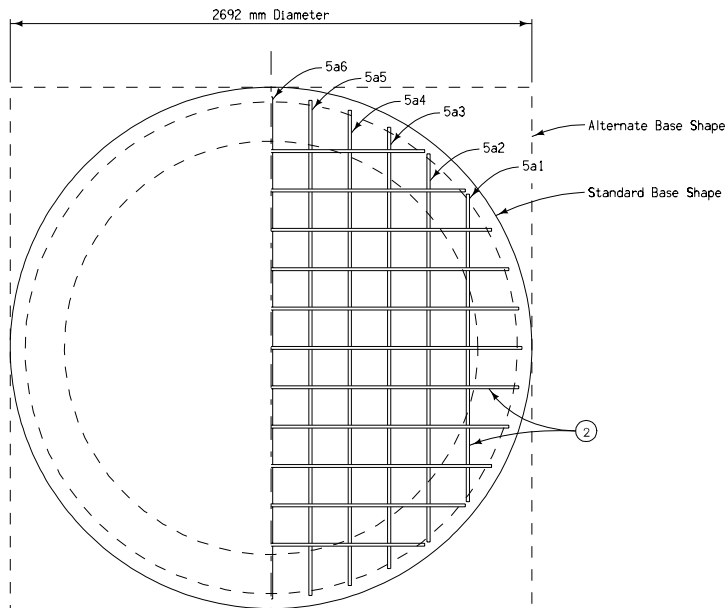

SECTION D-D
(BASE PLAN)

- ① Intake base may be cast in place or precast. If precast, the base and first wall section may be cast separately with a keyway or as one unit.
- ② #5 at 203 mm centers each direction or equivalent welded wire fabric.

BILL OF REINFORCING STEEL					
CIRCULAR INTAKE BASE - EPOXY COATED					
BAR	LOCATION	SHAPE	NO.	LENGTH	MASS
5a1	Base, Longit. & Transverse	—	4	1600	10.0
5a2	Base, Longit. & Transverse	—	4	2007	12.2
5a3	Base, Longit. & Transverse	—	4	2286	14.0
5a4	Base, Longit. & Transverse	—	4	2438	15.0
5a5	Base, Longit. & Transverse	—	4	2540	15.9
5a6	Base, Longit. & Transverse	—	2	2591	8.2
EPOXY COATED REINFORCING STEEL - TOTAL					75.3

The clear distance from face of concrete to near edge or end of reinforcing bar to be 51 mm, unless otherwise noted.

QUANTITY SUMMARY FOR CIRCULAR INTAKE BASE	
Concrete	1.8 m ³ *
Epoxy Coated Reinforcing Steel	75 kg *

* Based on Standard Base Shape

All dimensions given in millimeters unless noted.

M		
	STANDARD ROAD PLAN RA-47B(3)	
	REVISION: NEW APPROVED BY DESIGN METHODS ENGINEER	REVISION NO. NEW REVISION DATE 4-18-06
	TRIPLE GRATE BARRIER INTAKE, CIRCULAR (Sheet 3 of 3)	