

TYPE	WIDTH
CF-1	50
CF-2	65
CF-3	75
CF-4	90

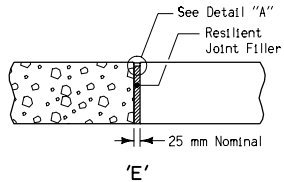

25 mm EXPANSION JOINT

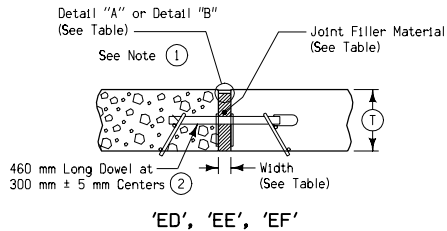

DOWELED EXPANSION JOINT

DOWELED EXPANSION JOINTS		
TYPE	WIDTH	FILLER MATERIAL (4)
ED	25	Resilient (Detail "A")
EE	50	Flexible Foam (Detail "A")
EF	90	Flexible Foam (Detail "B")

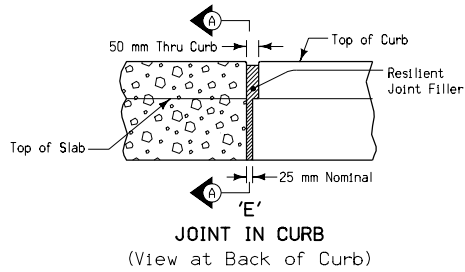

JOINT IN CURB

(View at Back of Curb)

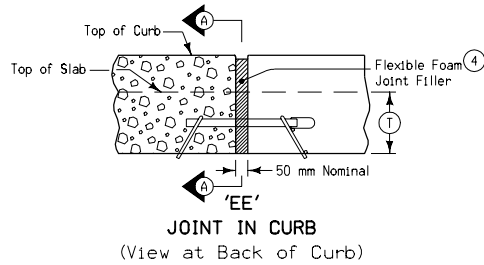

JOINT IN CURB

(View at Back of Curb)

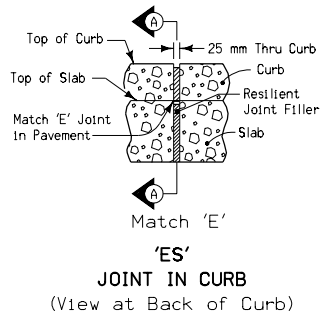

JOINT IN CURB

(View at Back of Curb)

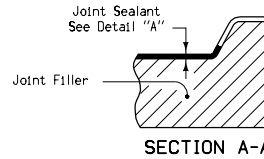

SECTION A-A

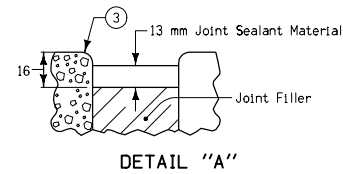

DETAIL "A"

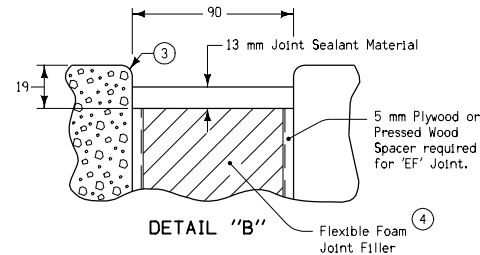

DETAIL "B"

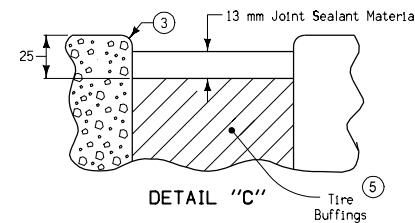

DETAIL "C"

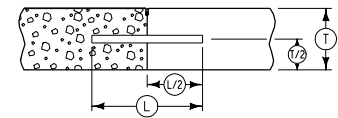

TYPICAL DOWEL PLACEMENT
Applies to all joints unless otherwise detailed.

- See Standard Road Plan RH-55 for dowel assembly fabrication details and placement limits. The free end of dowel bar shall be coated to prevent bond with pavement. At intake locations, dowel bars may be cast-in-place.
- Refer to Bar Size Table.
- Edge with 5 millimeter tool for length of joint indicated if formed; edging not required when cut with diamond blade saw.
- Holes for Joint Material shall be predrilled or preformed for appropriate dowel size.
- Compact tire buffings by spading with a square-nose shovel.

All dimensions given in millimeters unless noted.

M METRIC VERSION	 Iowa Department of Transportation	REVISION 12 04-17-07
		RH-52
	STANDARD ROAD PLAN <small>REVISIONS: Added note to compact tire buffings with square-nose shovel.</small>	
	<i>Deanna Mayfield</i> <small>APPROVED BY DESIGN METHODS ENGINEER</small>	
JOINTS (EXPANSION)		
SHEET 1 of 1		

BAR SIZE TABLE			
(T)	< 200 mm	> 200 mm but < 250 mm	> 250 mm
Dowel	19	31	38
Diameter (minimum)			