

R-12W

93

T-93N

T-92N

160TH ST
(TRIPOLI CORPORATE LIMITS)

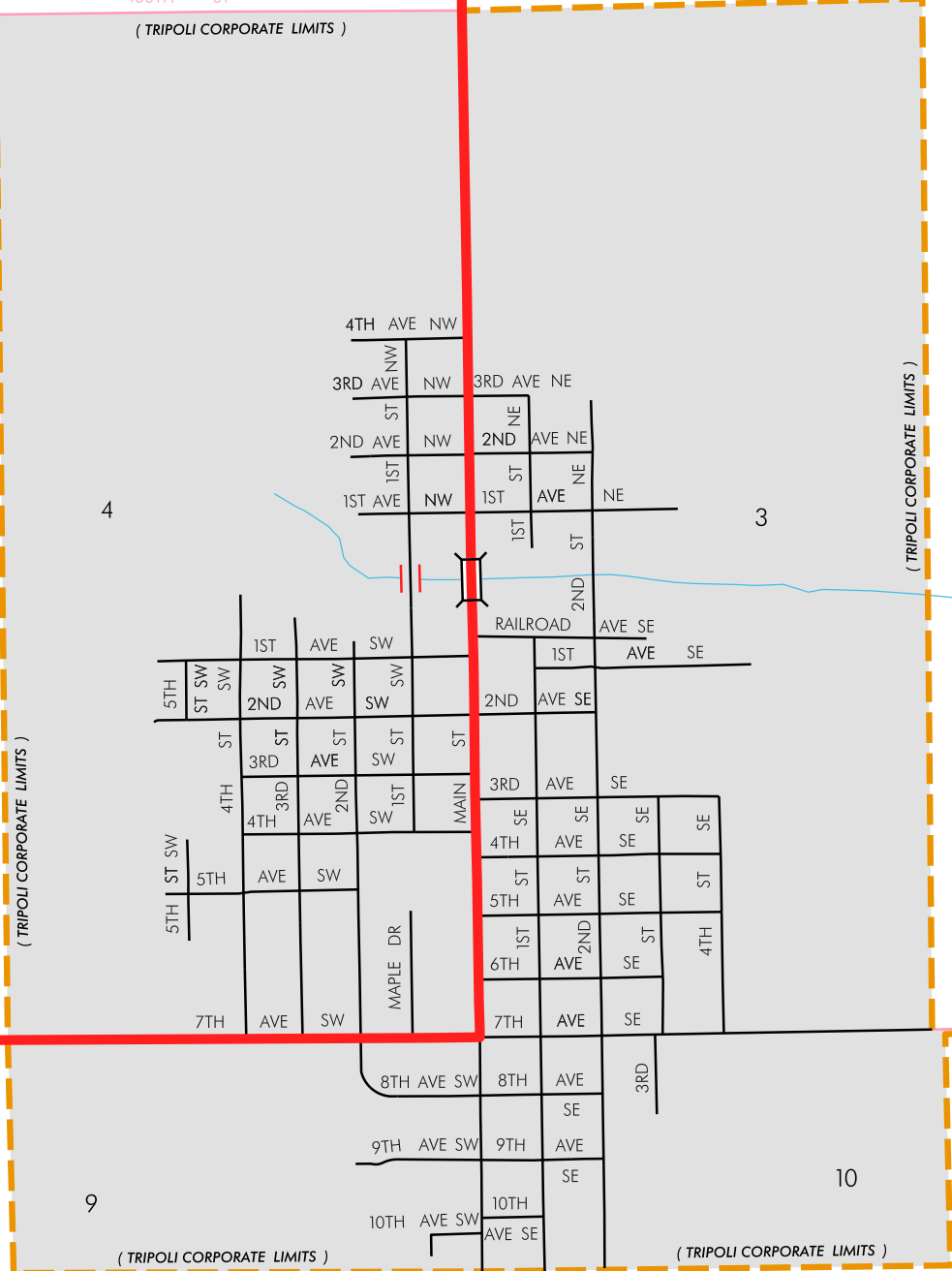

(TRIPOLI CORP. LIMITS) 170TH ST

(TRIPOLI CORP. LIMITS)

C28

QUAIL AVE

V43

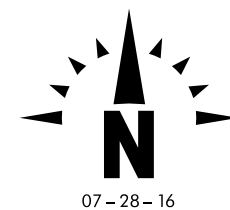

LEGEND

- INTERSTATE ROUTE
- FREEWAY OR EXPRESSWAY ROUTE
- U.S. NUMBERED ROUTE
- BUSINESS ROUTE
- STATE NUMBERED ROUTE
- UNSIGNED ROUTE
- COUNTY NUMBERED ROUTE
- SECONDARY ROAD OR ADJOINING CITY STREET
- CITY STREET
- PARK, INSTITUTION, OR FEDERAL ROAD
- RAILROAD
- CORPORATION LINE
- SECTION LINE
- CUL-DE-SAC
- SECTION, TOWNSHIP & RANGE NUMBERS

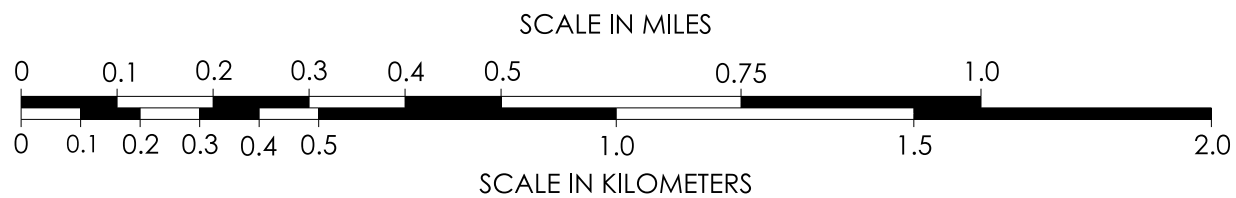

**HIGHWAY AND STREET MAP
OF
TRIPOLI
IOWA**

PREPARED BY
IOWA DEPARTMENT OF TRANSPORTATION
PLANNING, PROGRAMMING, AND MODAL DIVISION
OFFICE OF SYSTEMS PLANNING
PHONE (515) 239-1664
IN COOPERATION WITH
UNITED STATES DEPARTMENT OF TRANSPORTATION
FEDERAL HIGHWAY ADMINISTRATION

09-7735