

LEGEND

COUNTY LINE	-----
CIVIL TOWNSHIP	-----
COMPARISON LINE	-----
SECTION LINE	-----
INTERMITTENT STREAM	-----
NARROW STREAM	-----
PIPE LINE GAS	-----
HIGHWAY BRIDGE SMALL	-----
RAILROAD SINGLE OPERATING COMPANY	-----
RAILROAD STATION	-----
RAILROAD OVERHEAD	-----
RAILROAD OVER (SUBWAY)	-----
CENTER OF CITIES	-----
CENTER OF COUNTY SEAT	-----
RAILROAD GRADE CROSSING	-----
DELIMITING AREA (GENERALIZED)	-----
LAKE OR POND	-----
FEDERAL OR STATE PROPERTY (NAMED)	-----
MARSH	-----
UNIMPROVED ROAD (RURAL)	-----
GRAVEL AND DRAINED ROAD	-----
GRAVEL ROAD	-----
BITUMINOUS SURFACED ROAD	-----
PAVED ROAD	-----
LEGAL ROAD NOT OPEN TO TRAFFIC	-----

Highway and Transportation Map

WRIGHT COUNTY

IOWA

Prepared By
Iowa Department of Transportation
 Phone (515) 239-1289
 In Cooperation With
United States Department of Transportation

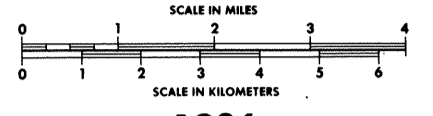

1986

LEGEND

FARM UNIT	-----	IN USE	9
DWELLING OTHER THAN FARM	-----	NOT IN USE	0
ROWS OR GROUPS OF DWELLINGS	-----		1
STORE OR SMALL BUSINESS ESTABLISHMENT	-----		2
SCHOOL OR OTHER EDUCATIONAL INSTITUTION	-----		3
CHURCH OR OTHER RELIGIOUS INSTITUTION	-----		4
CEMETERY	-----		5
GOLF GROUNDS OR COUNTRY CLUB	-----		6
STATE OR COUNTY HIGHWAY GARAGE	-----		7
GRAVEL PIT	-----		8
STOCK YARD	-----		9
TOURIST CAMP	-----		10
PICNIC GROUNDS	-----		11
GAME FARM	-----		12
GROUPS OF SEASONAL DWELLINGS	-----		13
UNITED STATES HIGHWAY	-----		14
STATE HIGHWAY SYSTEM	-----		15
COUNTY TRUNK SYSTEM	-----		16
FEDERAL AID HIGHWAY SYSTEM	-----		17
POINTS BETWEEN WHICH DISTANCES ARE MEASURED	-----		18
HIGHWAY WITH PARTIAL CONTROL OF ACCESS	-----		19
BOOSTER STATION	-----		20
RADIO STATION	-----		21
GRAIN ELEVATOR	-----		22
RACE TRACK	-----		23
BUSINESS AND POST OFFICES AND POST OFFICE BOXES	-----		24
GAUGING OR PUMPING STATION	-----		25
AIRPORT	-----		26
LANDING AREA OR STRIP	-----		27

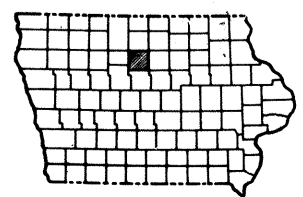
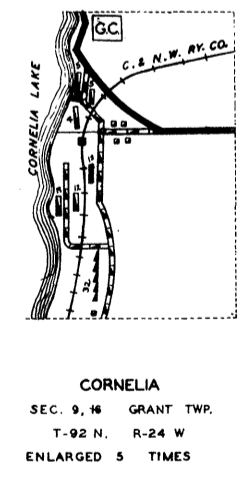
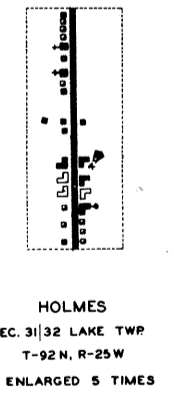
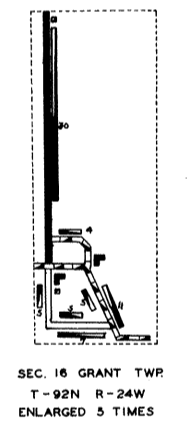
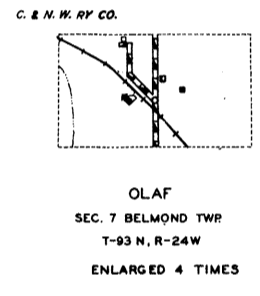
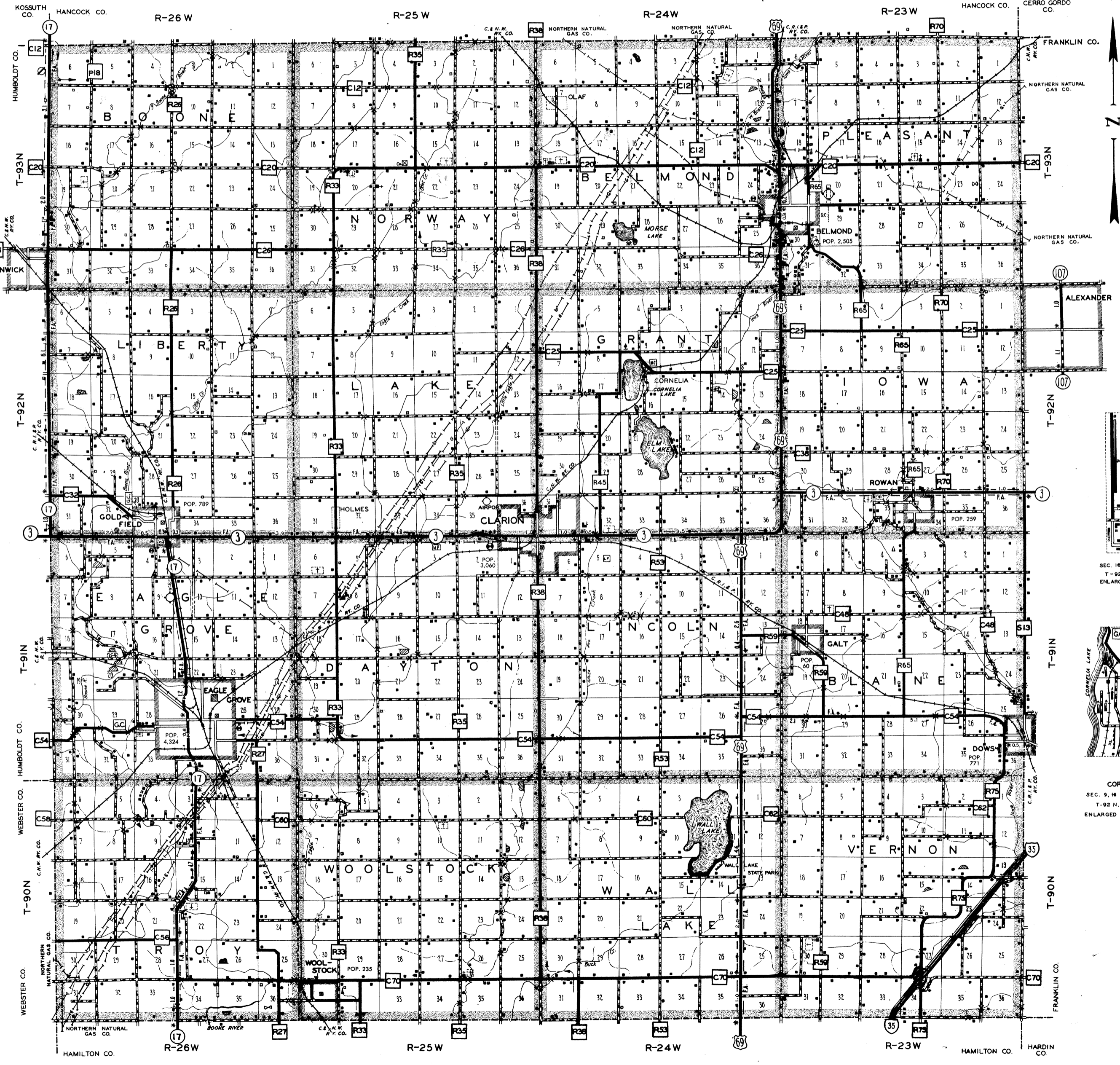

JANUARY 1, 1987