

R11-4
TYPE III
M4-10

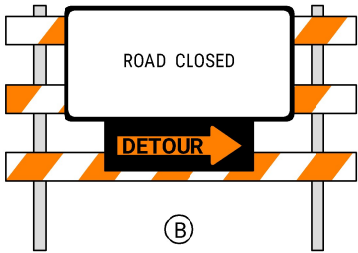

C

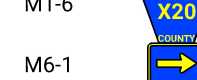

E

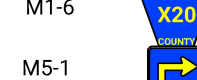

G



D



F

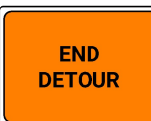

H

DETOUR ROUTE SIGNS
SCALE: NOT TO SCALE

KEY

PROJECT LIMITS
DETOUR ROUTE



- NOTES
1. THIS SHEET IS FOR REFERENCE ONLY. LINN COUNTY FORCES SHALL PROVIDE ALL LABOR AND MATERIALS REQUIRED FOR DETOUR. CONTRACTOR SHALL BE RESPONSIBLE FOR THE TRAFFIC CONTROL AS NOTED IN THE BID ITEM NOTES.
 2. TRAFFIC CONTROL DEVICES, PROCEDURES AND LAYOUTS, SIGNING AND PAVEMENT MARKINGS INSTALLED WITHIN THE LIMITS OF THIS PROJECT SHALL CONFORM TO "MANUAL ON UNIFORM TRAFFIC CONTROL DEVICES FOR STREETS AND HIGHWAYS" AS ADOPTED BY IOWA DOT PER 761 OF THE IOWA ADMINISTRATIVE CODE CHAPTER 130.

DRAFTED BY: <AAA> <MM-DD-YY>
REVISED BY: AAA MM-DD-YY
PLOTTED BY: SCHIRMER, MICHAEL
11/13/2024 14:28

REVISIONS:
DWG: S:\PROJECTS\HIGHWAY 51\INTERCHANGE AT SPRINGVILLE ROAD\DWG



Secondary Road Department

SPRINGVILLE ROAD
NHSX-151-3(130)-3H-57
INTERCHANGE CONSTRUCTION

DETOUR ROUTE

SHEET
F.01