

U.S. 30 and 610th Avenue Interchange

**PROJECT COST: \$31.4 Million***Current Programmed Amount***AADT: 15,000 to 17,000 (8% Trucks)***Annual Average Daily Traffic*

Purpose and Need for the Proposed Action

The purpose of the proposed action is to improve the level of safety and to improve traffic operations on U.S. 30 from the I-35 interchange near Ames to 11th Street in Nevada. The need for the proposed action is based on a combination of factors that include:

- Safety
- System Continuity
- Traffic Demand
- Roadway Deficiencies

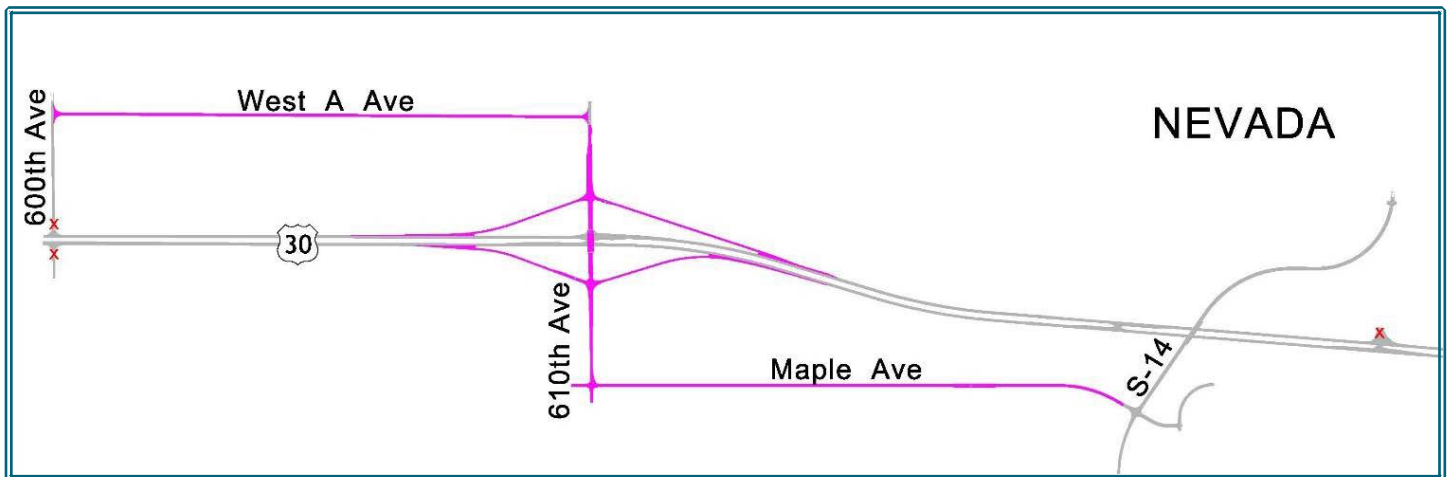

Project Information

- Construct a new diamond interchange at 610th Avenue/West 18th Street
- Extend West A Avenue from 610th Avenue to 600th Avenue
- Pave Maple Avenue from 610th Avenue to County Road S-14
- Close all existing at-grade intersections along U.S. 30 between the 580th Avenue and the 19th Street interchanges.
- The construction period will last from 2028-2030
- Right-of-way appraisals and negotiations will begin next month

Link to Project Plans and Presentation



Detour Map and Schedule

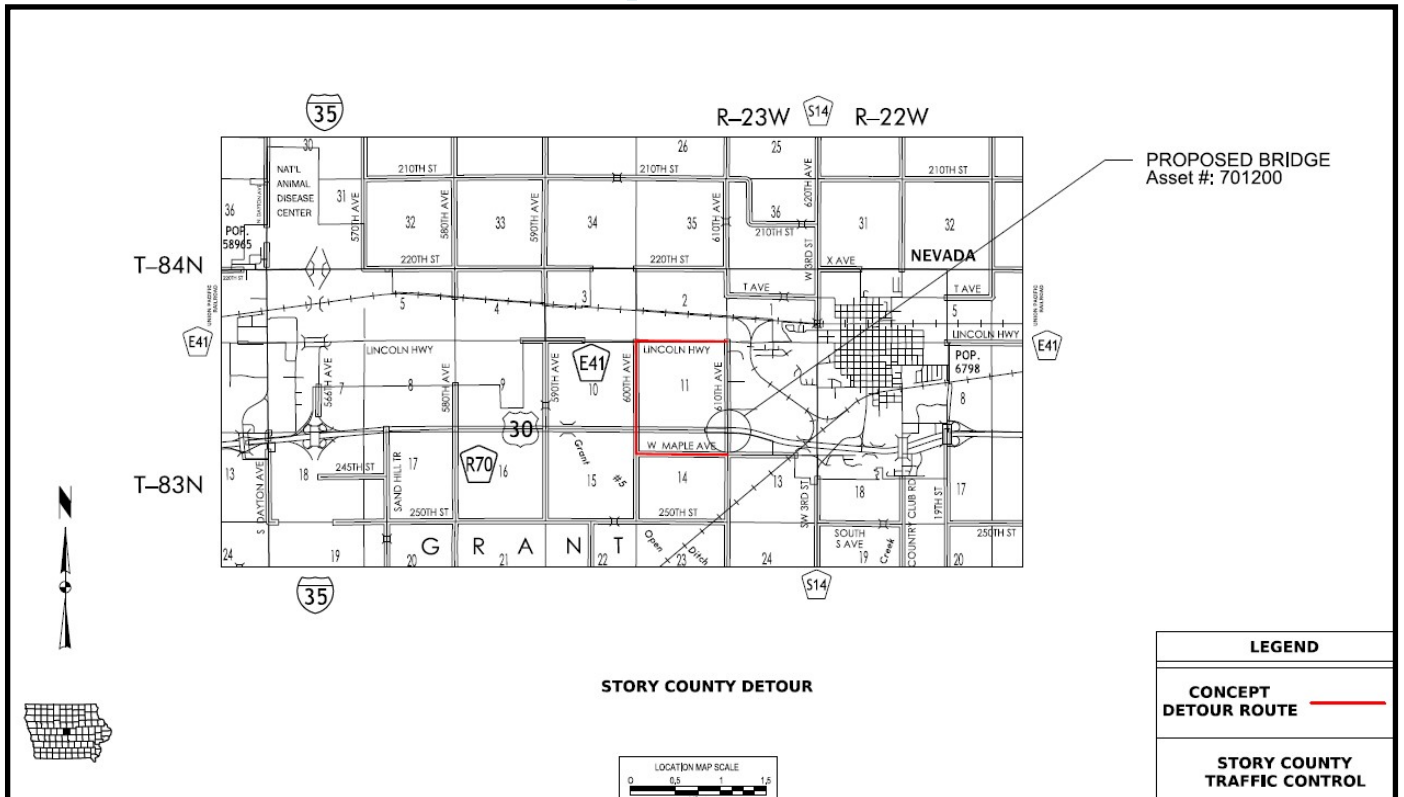

	2013-2024	2025	2026	2027	2028-2030
Environmental Reviews					
Preliminary Design					
Public Meeting					
Appraisals					
Right-of-way Negotiation					
Right-of-way Acquisition					
Final Design					
First Bid Letting					
Construction					