

AIRPORT DATA TABLE		
AIRPORT DATA	EXISTING	ULTIMATE
AIRPORT ELEVATION (MSL)	1361.0	1362.8
AIRPORT REFERENCE POINT (NAD 83)		
LATITUDE	41°19'37.88"N	41°19'38.08"N
LONGITUDE	94°28'42.81"W	94°28'37.29"W
AIRPORT ELECTRONIC AIDS	GPS	GPS
MEAN MAX TEMPERATURE OF THE HOTTEST MONTH	85.8	85.8
MAGNETIC VARIATION	2°12'E	0°0'W
DATE OF MAGNETIC VARIATION	2010	2030
NPAS SERVICE LEVEL	GENERAL AVIATION	GENERAL AVIATION
STATE SERVICE LEVEL	GENERAL SERVICE	GENERAL SERVICE
AIRPORT REFERENCE CODE	A-I	B-II
DESIGN AIRCRAFT	BEECH 200	BEECH 200

RUNWAY DATA TABLE				
RUNWAY DATA	RUNWAY 14 / 32		RUNWAY 7 / 25	
	EXISTING	ULTIMATE	EXISTING	ULTIMATE
AIRPORT REFERENCE CODE (APC)	A-I	A-I	A-I	B-II
RUNWAY LENGTH	2500	2250	3400	4400
RUNWAY WIDTH	50'	60'	60'	75'
EFFECTIVE GRADIENT (%)	0.24%	0.20%	0.22%	0.10%
MAXIMUM GRADIENT CHANGE	6.1"	4.6"	7.4"	4.4"
RUNWAY LIGHTING	MIRL	NONE	MIRL	MIRL
RUNWAY MARKINGS	NP	BASIC	NP	NP
PAVEMENT MATERIAL	PCC	PCC	PCC	PCC
PAVEMENT DESIGN STRENGTH				
SINGLE WHEEL	12,500 LBS	12,500 LBS	12,500 LBS	12,500 LBS
DUAL WHEEL				
RUNWAY SAFETY AREA (RSA)				
LENGTH BEYOND RUNWAY	240	240	240	300
WIDTH	120	120	120	150
RUNWAY OBJECT FREE AREA (ROFA)				
LENGTH BEYOND RUNWAY	240	240	240	300
WIDTH	250	250	250	500
OBSTACLE FREE ZONE (OFZ)	2900 X 250	2650 X 250	3800 X 250	4800 X 400
TAXIWAY WIDTH			35	35
TAXIWAY LIGHTING				MTL
APPROACH SURFACE SLOPE	20:1 / 20:1	14 / 32	20:1 / 20:1	34:1 / 34:1
ELECTRONIC AIDS	NONE / NONE	NONE / NONE	GPS / GPS	GPS / GPS
VISUAL APPROACH AIDS	VASI-2, REIL / VASI-2, REIL	NONE / NONE	NONE/NONE	PAPI-2, REIL / PAPI-2, REIL
APPROACH VISIBILITY MINIMUMS	1 MILE / 1 MILE	VISUAL / VISUAL	1 MILE / 1 MILE	1 MILE / 1 MILE
FAR PART 77 CATEGORY	A(V) / A(NP)	A(V) / A(V)	A(V) / A(V)	A(NP) / A(NP)
AERONAUTICAL SURVEY TYPE REQUIRED	NONE	NONE	NONE	WITH VERTICAL GUIDANCE
TDZ ELEVATION (MSL)	1361.5 / 1361.5	1360.0 / 1360.0	1362.4 / 1362.8	1362.4 / 1362.8
RUNWAY END COORDINATES (NAD 83)				
LATITUDE	41°19'46.843"N / 41°19'27.277"N	41°19'46.843"N / 41°19'29.231"N	41°19'25.448"N / 41°19'41.806"N	41°19'35.448"N / 41°19'43.791"N
LONGITUDE	94°27'02.070"W / 94°28'42.000"W	94°27'02.070"W / 94°28'44.076"W	94°28'57.529"W / 94°28'13.789"W	94°28'57.529"W / 94°28'00.826"W
RUNWAY END ELEVATIONS (MSL)	1355.4 / 1361.5	1355.4 / 1360.0	1357.7 / 1362.8	1357.7 / 1359.8
TAKEOFF RUN AVAILABLE (TORA)	2500	2250	3400	4400
TAKEOFF DISTANCE AVAILABLE (TODA)	2500	2250	3400	4400
ACCELERATE STOP DISTANCE AVAILABLE	2500	2250	3400	4400
LANDING DISTANCE AVAILABLE (LDA)	2500	2250	3400	4400

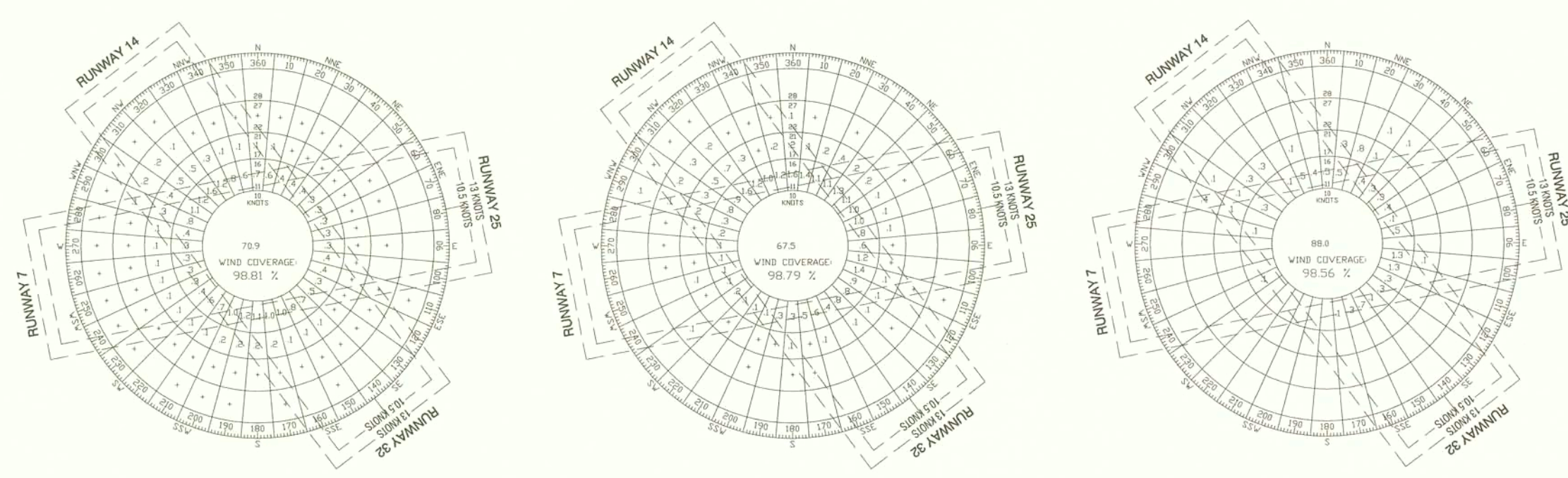

WIND COVERAGE				
RUNWAY	ALL WEATHER	IFR CONDITIONS	CLOSED CONDITIONS	
7/25	92.70%	88.76%	82.27%	83.78%
14/32	90.70%	95.20%	86.41%	93.85%
Combined	95.96%	98.81%	95.96%	97.71%

8.0% OF ALL-WEATHER READINGS WERE IFR CONDITIONS

NOTES:  
 THERE ARE NO OFZ OBJECT PENETRATIONS.  
 THERE ARE NO THRESHOLD SITING SURFACE OBJECT PENETRATIONS.  
 THERE ARE NO MODIFICATIONS TO AIRPORT DESIGN STANDARDS  
 AIRSPACE CASE NO. 2012-ACE-2036-NRA

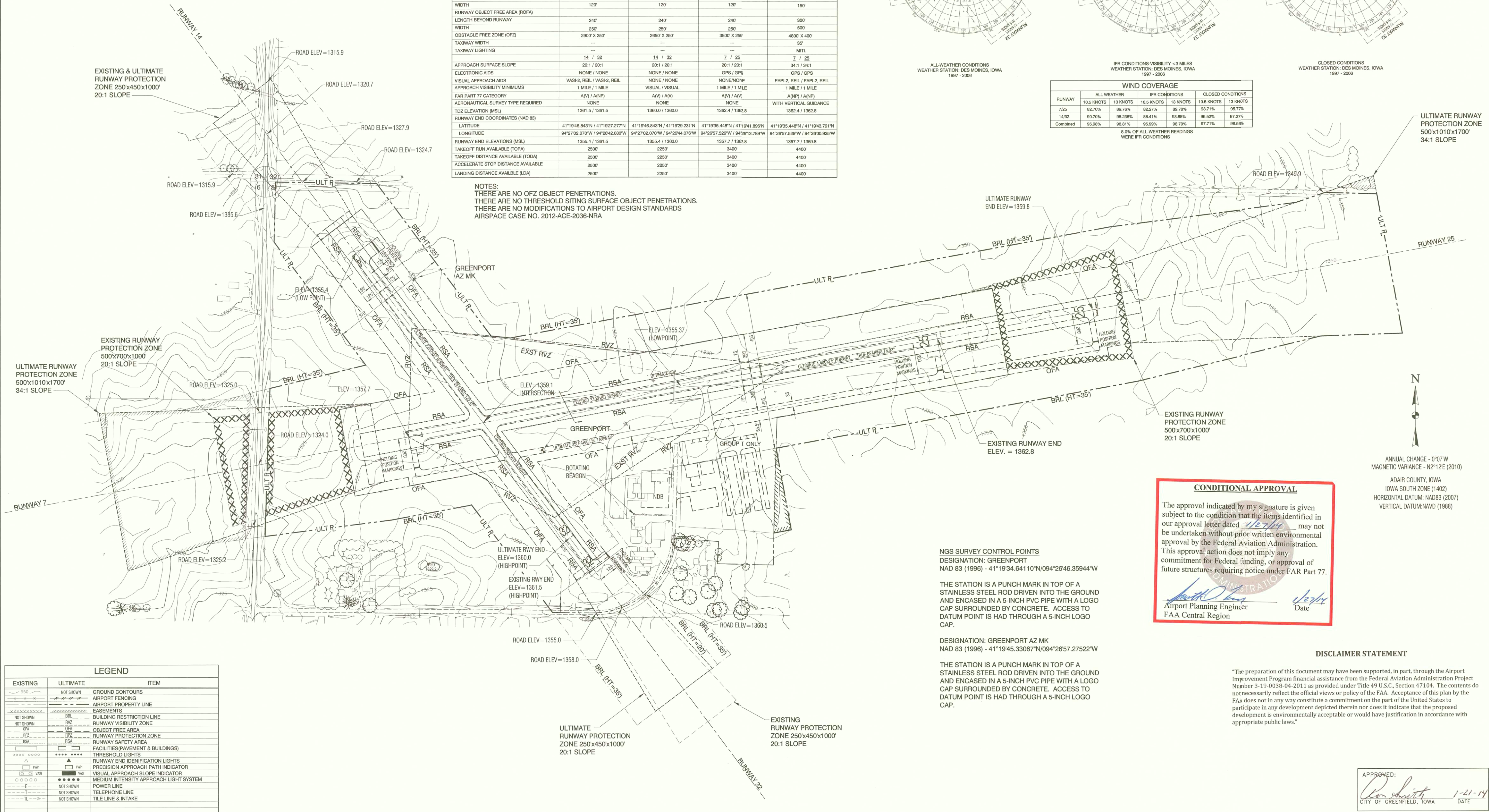

LEGEND		
EXISTING	ULTIMATE	ITEM
---	---	GROUND CONTOURS
---	---	AIRPORT FENCING
---	---	AIRPORT PROPERTY LINE
---	---	EASEMENTS
---	---	BUILDING RESTRICTION LINE
---	---	RUNWAY VISIBILITY ZONE
---	---	OBJECT FREE AREA
---	---	RUNWAY SAFETY AREA
---	---	RUNWAY PROTECTION ZONE
---	---	RUNWAY SAFETY AREA
---	---	FACILITIES (PAVEMENT & BUILDINGS)
---	---	THRESHOLD LIGHTS
---	---	RUNWAY END IDENTIFICATION LIGHTS
---	---	PRECISION APPROACH PATH INDICATOR
---	---	VISUAL APPROACH SLOPE INDICATOR
---	---	MEDIUM INTENSITY APPROACH LIGHT SYSTEM
---	---	POWER LINE
---	---	TELEPHONE LINE
---	---	TILE LINE & INTAKE

NGS SURVEY CONTROL POINTS  
 DESIGNATION: GREENPORT  
 NAD 83 (1996) - 41°19'34.64110"N/94°26'46.35944"W

THE STATION IS A PUNCH MARK IN TOP OF A STAINLESS STEEL ROD DRIVEN INTO THE GROUND AND ENCASED IN A 5-INCH PVC PIPE WITH A LOGO CAP SURROUNDED BY CONCRETE. ACCESS TO DATUM POINT IS HAD THROUGH A 5-INCH LOGO CAP.

DESIGNATION: GREENPORT AZ MK  
 NAD 83 (1996) - 41°19'45.33067"N/94°28'57.27522"W

THE STATION IS A PUNCH MARK IN TOP OF A STAINLESS STEEL ROD DRIVEN INTO THE GROUND AND ENCASED IN A 5-INCH PVC PIPE WITH A LOGO CAP SURROUNDED BY CONCRETE. ACCESS TO DATUM POINT IS HAD THROUGH A 5-INCH LOGO CAP.

**CONDITIONAL APPROVAL**

The approval indicated by my signature is given subject to the condition that the items identified in our approval letter dated 1/27/14 may not be undertaken without prior written environmental approval by the Federal Aviation Administration. This approval action does not imply any commitment for Federal funding, or approval of future structures requiring notice under FAR Part 77.

*[Signature]*  
 Airport Planning Engineer  
 FAA Central Region

1/27/14  
 Date

**DISCLAIMER STATEMENT**

"The preparation of this document may have been supported, in part, through the Airport Improvement Program financial assistance from the Federal Aviation Administration Project Number 3-19-0038-04-2011 as provided under Title 49 U.S.C., Section 47104. The contents do not necessarily reflect the official views or policy of the FAA. Acceptance of this plan by the FAA does not in any way constitute a commitment on the part of the United States to participate in any development depicted therein nor does it indicate that the proposed development is environmentally acceptable or would have justification in accordance with appropriate public laws."

APPROVED:  
*[Signature]*  
 CITY OF GREENFIELD, IOWA  
 1-21-14  
 DATE

J:\4371\DWG\ALP UPDATE 7-10-12\bas.dwg - SH02 - 01-17-14 - 2:27pm - vml278

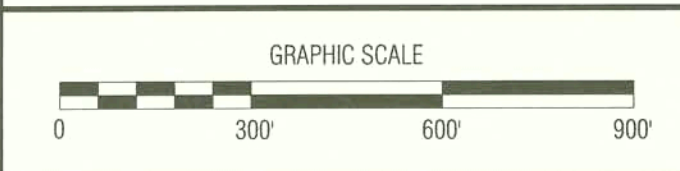

NO.	REVISION	BY	DATE	NO.	REVISION	BY	DATE
1	AS BUILT - AIP #3-19-0038-02	TJA	9-21-07				
2	UPDATE - AIP #3-19-0038-02	RAG	3-15-12				

**CGA**  
 Clapsaddle-Garber Associates, Inc.  
 16 East Main Street  
 Marshalltown, Iowa 50158  
 Ph 641-792-6701  
 www.cgaconsultants.com

DESIGNED: \_\_\_\_\_ DATE: \_\_\_\_\_  
 DRAWN: \_\_\_\_\_ DATE: \_\_\_\_\_  
 CHECKED: \_\_\_\_\_ DATE: \_\_\_\_\_  
 APPROVED: \_\_\_\_\_ DATE: \_\_\_\_\_

**GREENFIELD MUNICIPAL AIRPORT**  
 GREENFIELD, IOWA

**AIRPORT LAYOUT PLAN**  
 PROJECT NO. 4371.03  
 SHEET NO. 2 OF 10