

Grinnell

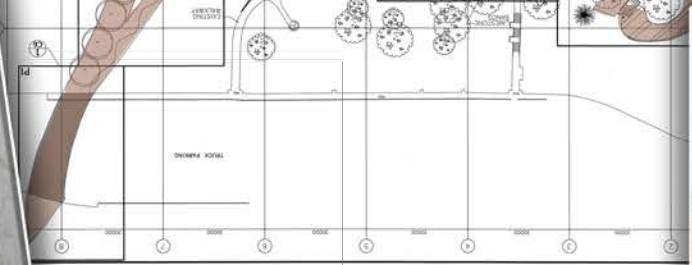

Jasper County  
I-80 Eastbound at milepost 181  
Artist: William Conway  
Completed: November 1999



A favorite for children, the search for the word “PIONEER” in large letters across the landscape keeps the younger traveler entertained, while more wistful wanderers are treated to one of the best views of the Iowa countryside down one of many nature trails.



In August and September millions of monarch butterflies light at this site on their migration south.



On days when the weather doesn’t lend itself to outdoor exploration, stories and photos embedded on the tile walls inside the structure tell the tales of early Iowa settlers.



For those non-Midwesterners, one of the wall blocks is glass containing shelled corn in an airtight container.

For those non-Midwesterners, one of the wall blocks is glass containing sh



“For Iowa, the land serves as more than just a backdrop. It is the major story line.”<sup>3</sup> Its rich prairie history, as writer Paul Engle called it – courted settlement. Thus, pioneers in this prairie have often drawn inspiration from the rhythms of rural life.

Regional cultures are born from the land and people. These ties, both powerful and also be complex and unclear. The way we use land and space to create communities and common bonds can also create different points of view.

We invite you to think expansively about what have been, and to be, a pioneer in Iowa.