

Highway and Transportation Map

LYON COUNTY IOWA

Prepared By



Iowa Department of Transportation

Phone (515) 239-1289

In Cooperation With

United States Department of Transportation

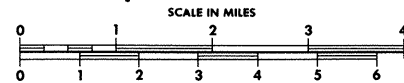

1986

LEGEND

STATE LINE	---
COUNTY LINE	- - - -
CIVIL TOWNSHIP	-----
CORPORATION LINE	-----
SECTION LINE	-----
INTERMITTENT STREAM	~~~~~
NARROW STREAM	~~~~~
WIDE STREAM	~~~~~
HIGHWAY BRIDGE SMALL	---X---
HIGHWAY BRIDGE LARGE	---X---
RAILROAD SINGLE OPERATING COMPANY	-----
RAILROAD STATION	○
RAILROAD BELOW (OVERHEAD)	---X---
RAILROAD OVER (SUBWAY)	---X---
CENTER OF CITIES	●
CENTER OF COUNTY SEAT	●
RAILROAD GRADE CROSSING	---X---
FEDERAL OR STATE PROPERTY (NAMED)	-----
DELIMITING AREA (GENERALIZED)	-----
PIPE LINE (OIL)	-----
GRADED AND DRAINED ROAD	-----
GRAVEL ROAD	-----
BITUMINOUS SURFACED ROAD	-----
PAVED ROAD	-----
LEGAL ROAD NOT OPEN TO TRAFFIC	-----
PIPE LINE (GAS)	-----
HIGHWAY WITH PARTIAL CONTROL OF ACCESS	-----
4 LANE HIGHWAY NOT DIVIDED	-----

LEGEND

FARM UNIT	○
DWELLING OTHER THAN FARM	○
ROWS OR GROUPS OF DWELLINGS	○
STORE OR SMALL BUSINESS ESTABLISHMENT	○
CHURCH OR OTHER RELIGIOUS INSTITUTION	○
SCHOOL OR OTHER EDUCATIONAL INSTITUTION	○
CEMETERY	○
TOWN HALL OR COMMUNITY HALL	○
FACTORY OR INDUSTRIAL PLANT	○
SEASONAL INDUSTRY	○
INTENSIVE RECREATION AREA	○
POWER SUBSTATION	○
GRAVEL PIT	○
TRIANGULATION STATION	○
UNITED STATES HIGHWAY	○
STATE HIGHWAY SYSTEM	○
COUNTY TRUNK SYSTEM	○
FEDERAL AID HIGHWAY SYSTEM	○
POINTS BETWEEN WHICH DISTANCES ARE MEASURED	○
LANDING STRIP OR AIRFIELD	○
GAUGING OR PUMPING STATION	○
AUTO JUNK YARD	○
SANITARY LAND FILL	○
BOOSTER STATION	○
COUNTRY CLUB OR GOLF COURSE	○
SMALL PARK (COUNTY) (WAYSIDE)	○
AIRPORT, LIMITED FACILITIES	○

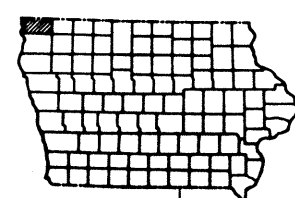
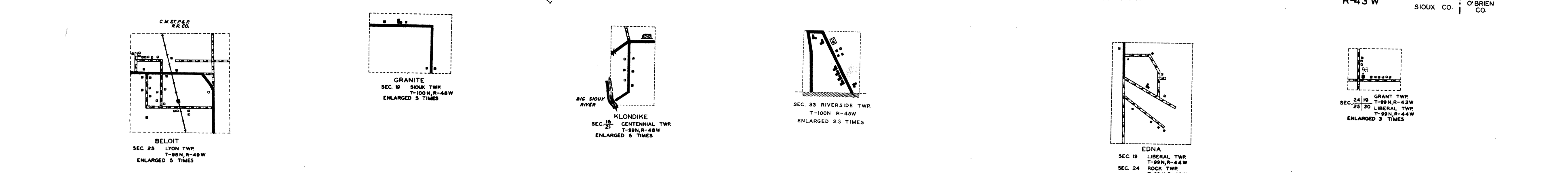
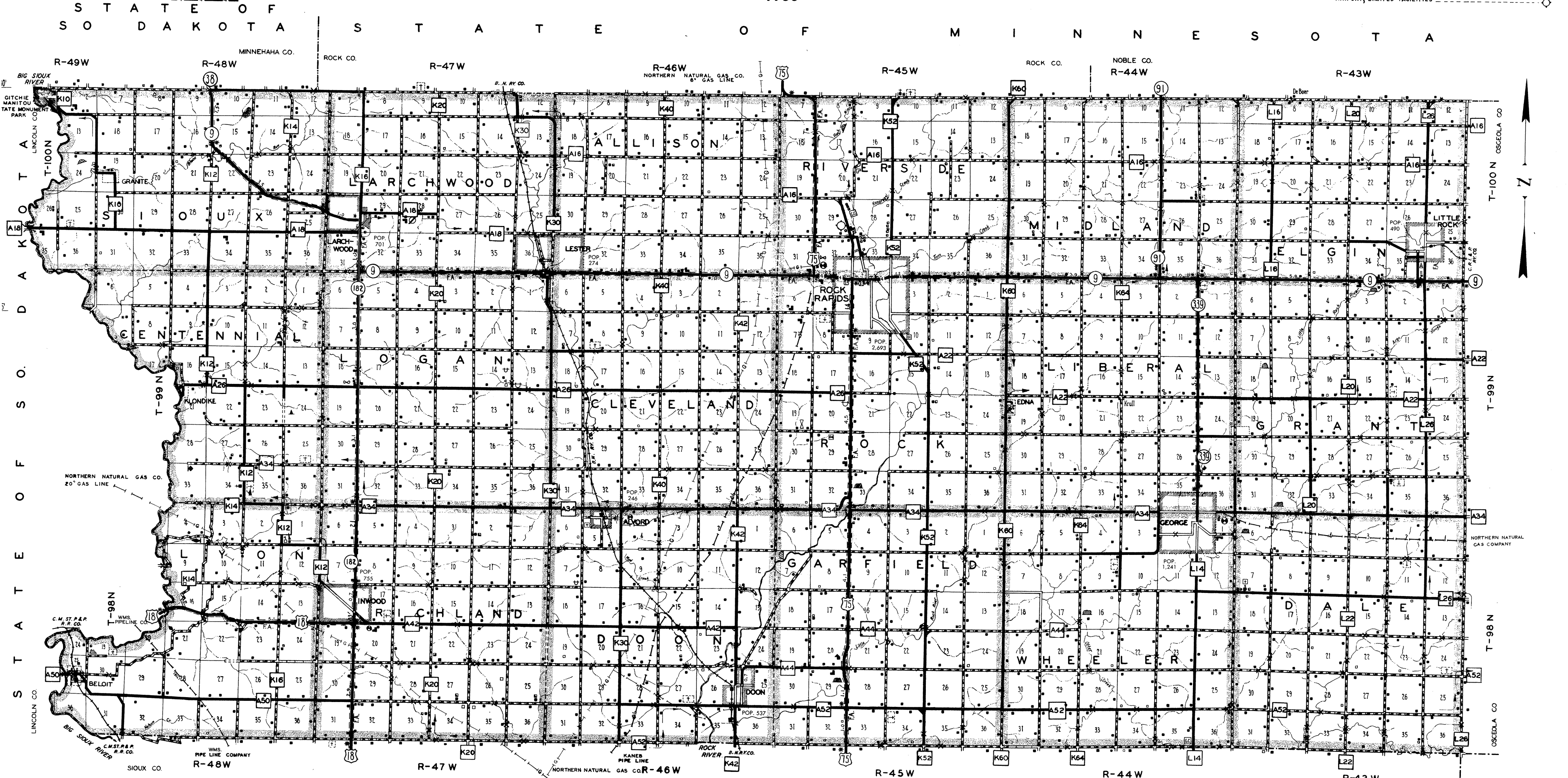

JANUARY 1, 1987