



Iowa Freight Advisory Council

Doug Martin // Amazon // DSM5

Friday, December 10, 2021



SSSPacer

- ▶ Safety - Push in chairs
- ▶ Standard Work- Raise your hand if you have a question and participate in the presentation
- ▶ Sustainability Tip- Turn off the lights when you leave the room
- ▶ DEI Tip - Use Peoples preferred Name
- ▶ Success Story- Amazon's Iowa Footprint

Agenda

- ▶ Introduction
- ▶ Overview of the Amazon Supply Chain
- ▶ Building type overview
- ▶ Fulfillment Center Deep Dive
 - ▶ Fun Facts
 - ▶ Product flow
- ▶ Amazon's Iowa Foot Print
- ▶ What Can the Label tell me about the Journey?
- ▶ Amazon's Supply Chain Statistics and future

Doug Martin Introduction

- ▶ Who Am I and what do I do?
- ▶ Time with Amazon- 5 Peaks, 4 primes
- ▶ Sort Centers (Final and Middle Mile) and *Fulfillment*
- ▶ 11 years in the Rail Industry
- ▶ Fun Fact
- ▶ Disclaimer

RETAIL SUPPLIER
FBA SUPPLIER

transportation

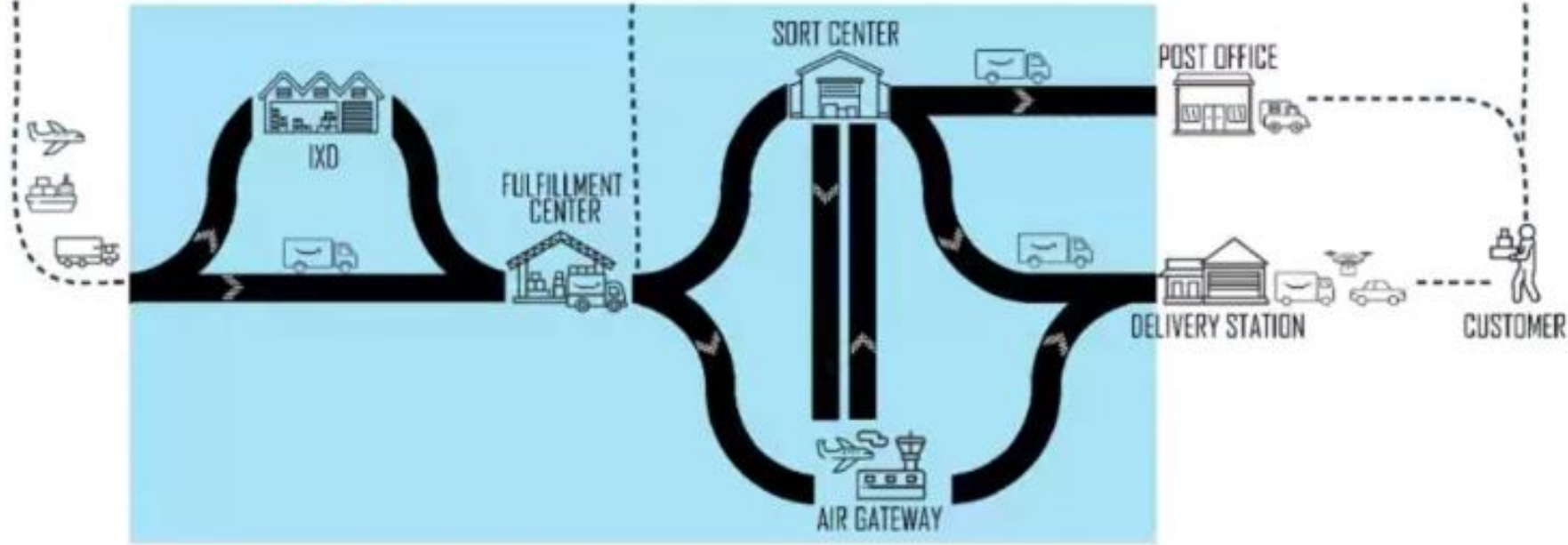
Amazon Transportation Services – Middle Mile

Amazon Building Types

▶ IXD's

- ▶ 22 in North America
- ▶ Full time employees
- ▶ Product Placement
- ▶ Vendor Product in, Totes or pallets out
- ▶ 53 Ft trailers-Outbound

▶ Fulfillment Centers

- ▶ Various types
 - ▶ Amazon Robotics (AR) -65 buildings
 - ▶ Differ in capacity and internal structure
 - ▶ Non Sortable- 53 buildings
- ▶ Product storage and fulfillment
- ▶ Full and PT employees
- ▶ 53ft trailers IB and OB

▶ Sort Centers

- ▶ Full and Part Time employees
- ▶ Boxes in Boxes out
- ▶ Can operate between 8 and 24 hours depending on volume
- ▶ Various transportation methods used depending on next destination

▶ Deliver Stations

- ▶ 800 buildings Globally
- ▶ Full and Part time employees
- ▶ UTR and OTR org's
- ▶ Various transportation methods used
 - ▶ DSP's and Flex

Why does Amazon need so many buildings?

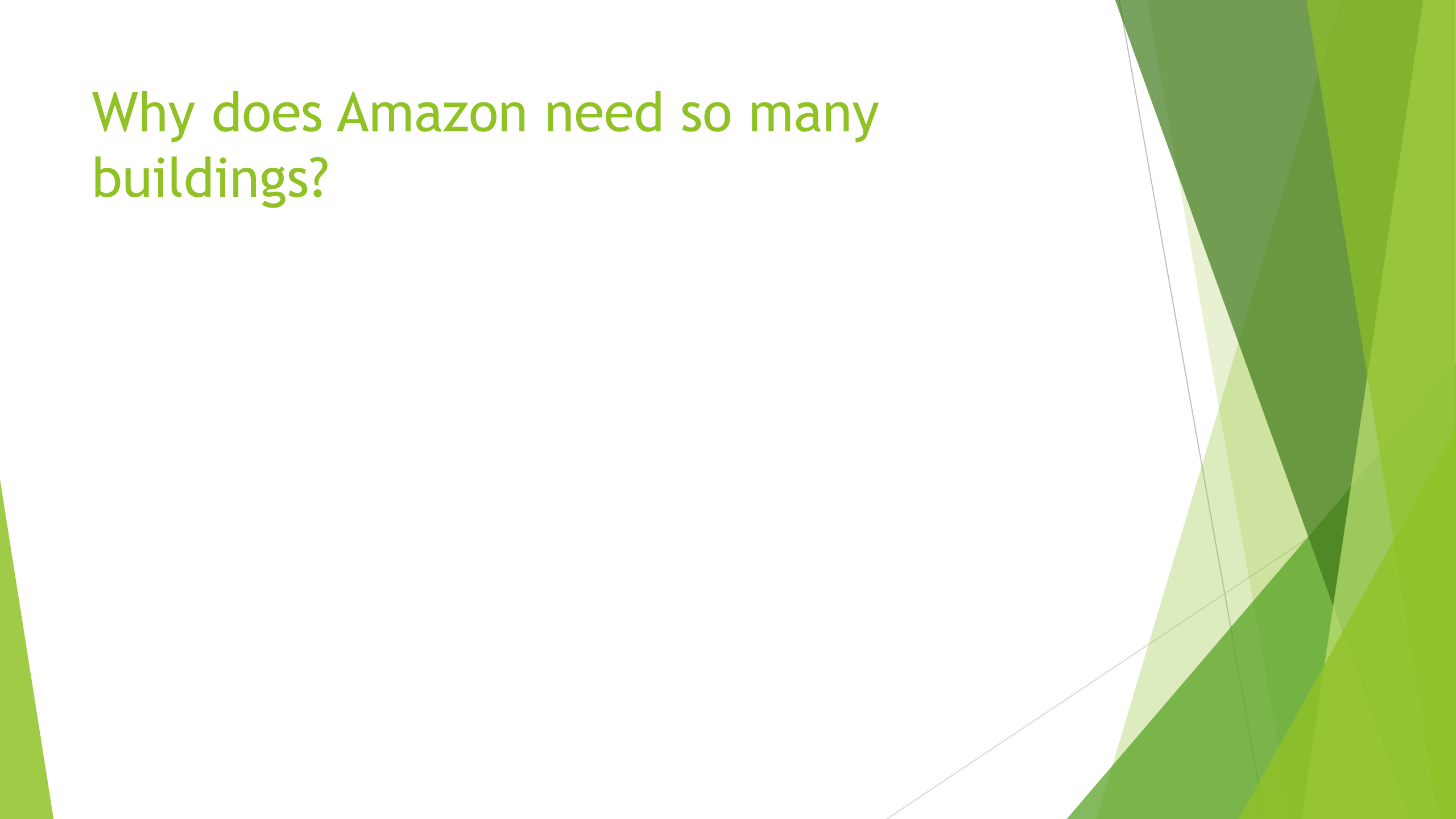

DSM5 Fun Facts

Enough structural steel to build the Eiffel Tower THREE times!

640 operational footprint, 4 floors = 2.5MMsq ft.
= fit 12 footballs fields inside building

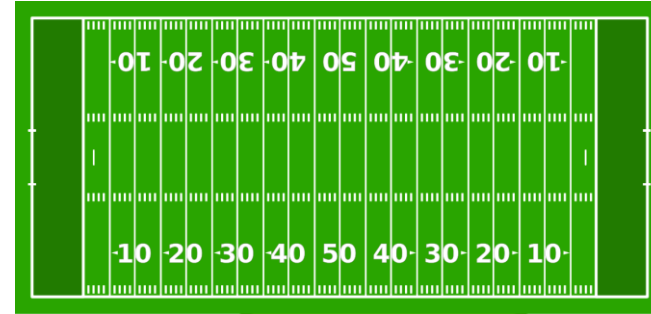

ARS - 4k drives/robots, 40 MM inventory, 1 MM IB & OB, older sides hold 27 MM inventory



13 miles of conveyance

Putting items into inventory

- ▶ Stowers
 - ▶ Pods come to them
 - ▶ The types of pods the get will depend on the type of inventory that they have on their station
 - ▶ Stowers place items into pods and the system registers what bin they put them in (touchless)



Amazon Robotics floor

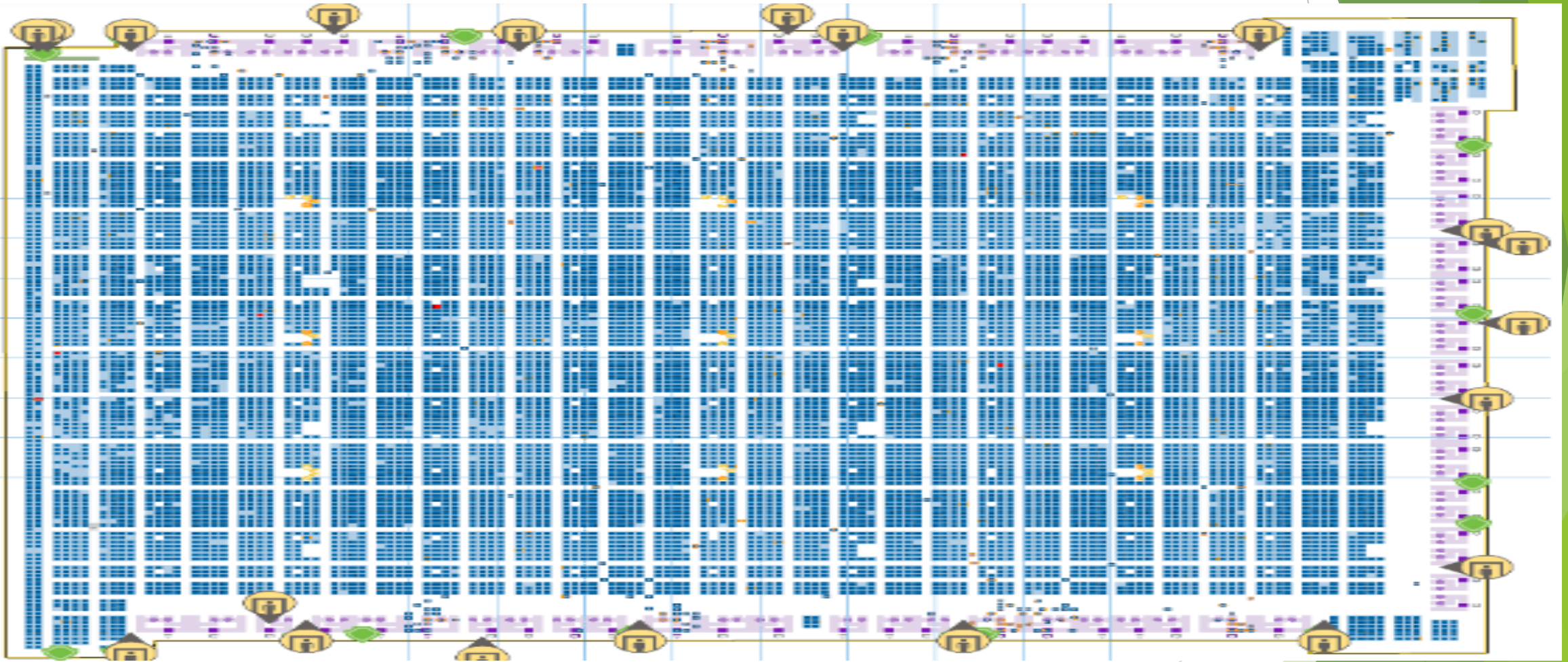

Amazon Robotics floor

► Stations and Pod Queues

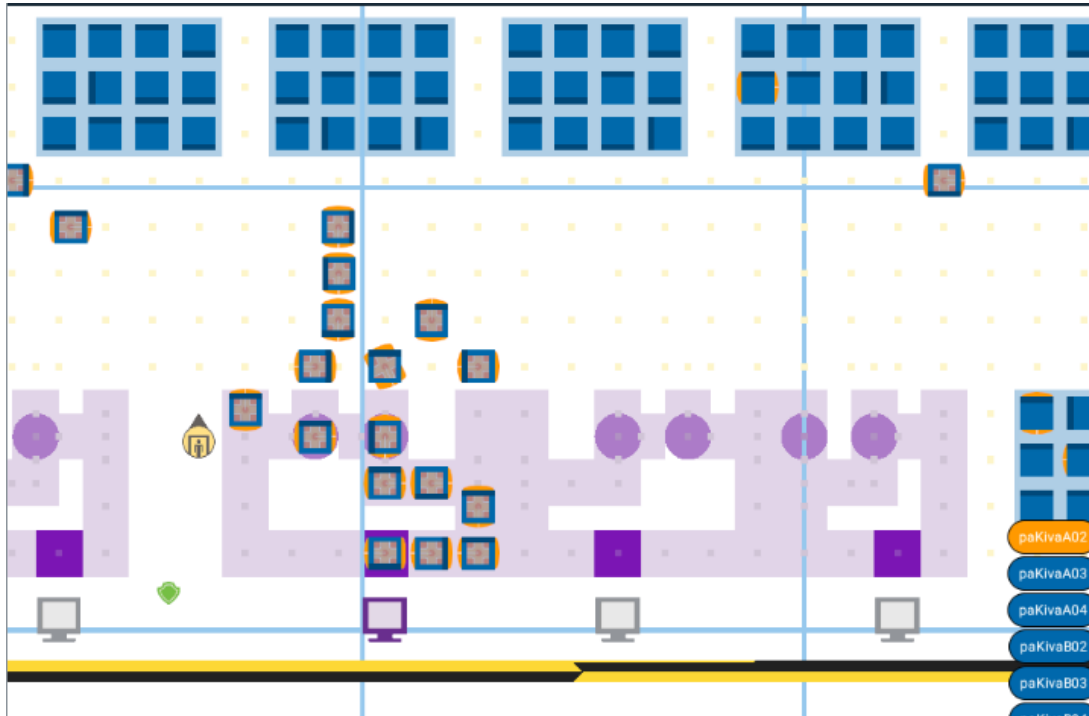

• Highways and ??

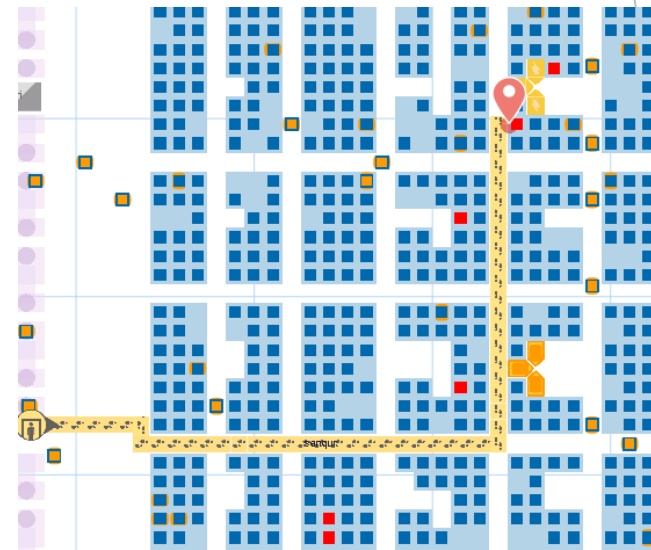

Amazon's Iowa Footprint

- ▶ DSM5- Fulfillment- Bondurant
- ▶ DSM9- Sort Center- Bondurant
- ▶ DIA3- Grimes- AMZL
- ▶ Grimes- XL Center
- ▶ Ankeny- AMZL
- ▶ Davenport- Fulfillment- 2022
- ▶ Iowa City- AMZL
- ▶ DSM- Airport



What can my package label tell me about the journey?

- ▶ Origin Fulfillment Center
- ▶ Sort Center
- ▶ AMZL location (if applicable)
- ▶ Deliver by Date
- ▶ Final Destination



What can my package label tell me about the journey?

- ▶ Origin Fulfillment Center
- ▶ Sort Center
- ▶ AMZL location (if applicable)
- ▶ Deliver by Date
- ▶ Final Destination



Lets look at one more

- ▶ What Fulfillment Center did it come from?
- ▶ Where is it going?
- ▶ What Sort Center was used?
- ▶ What is different about the final mile delivery?



Amazon Fleet Information

- ▶ Port of entry capacity- 50% increase from the start of the pandemic
- ▶ Air craft Fleet- 85
- ▶ Trailer Pool- 50,000
- ▶ 800 Delivery Stations (globally)
 - ▶ 260,000 Drivers
- ▶ 15 metro Areas-5 hour delivery
- ▶ 100,000 Rivan vans on the road by 2030
- ▶ 700 CNG vehicles (Class 6 and Class 8)

Questions?